

TAYLOR
STUDIOS INC.
1328 Warden Rd.
Tomball, TX 77375
281.263.4374
www.taylorstudios.com
All examples and designs represented on this document are the property of
Taylor Studios, Inc. and are for use on the project specified on this document.
They are not to be used for any other purpose without the express permission
of Taylor Studios, Inc. ©2010 Taylor Studios, Inc. All rights reserved.

DESCRIPTION:
Gallery Floor Plan

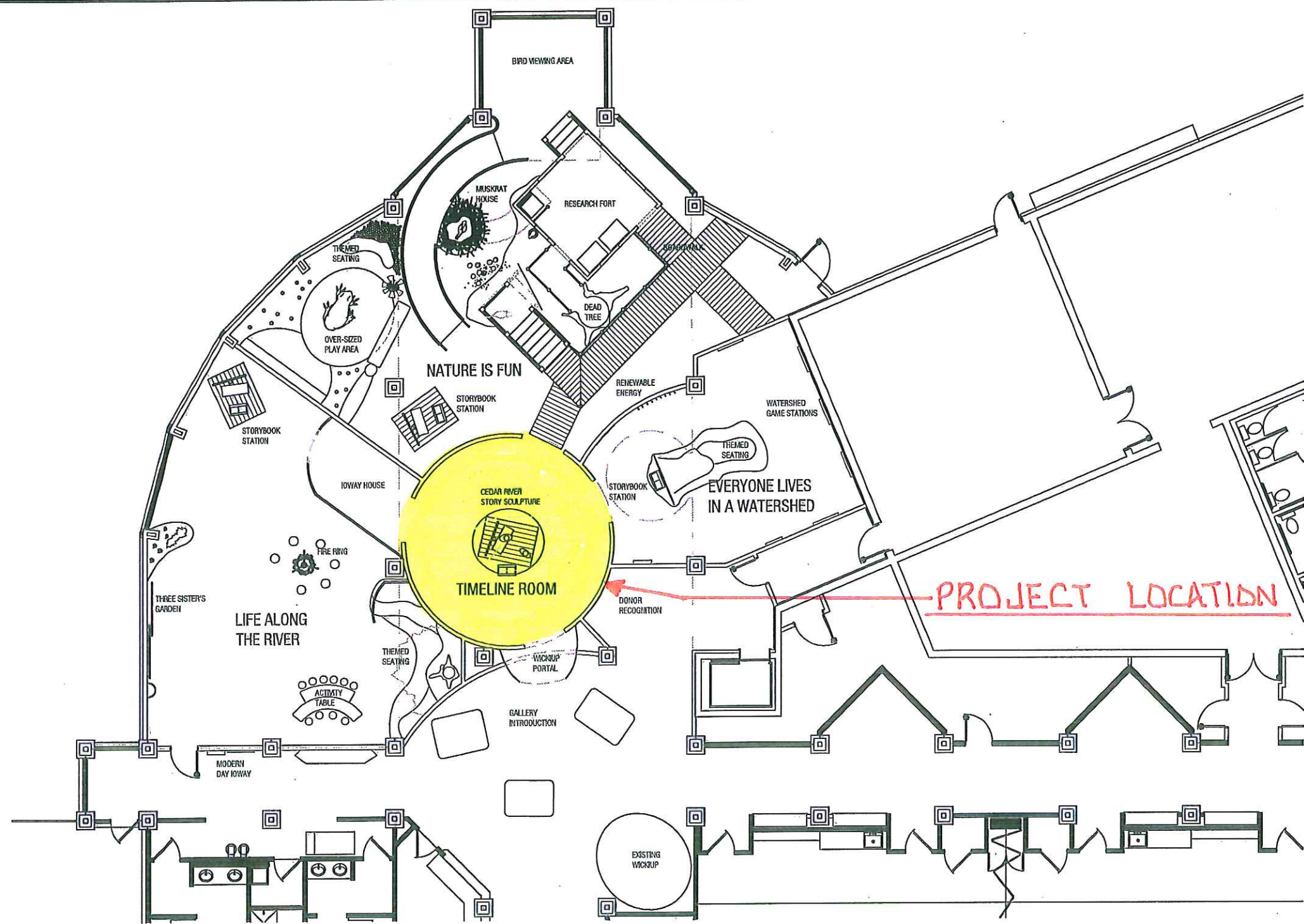

1 FLOOR PLAN
1 SCALE: 1/8" = 1' - 0"

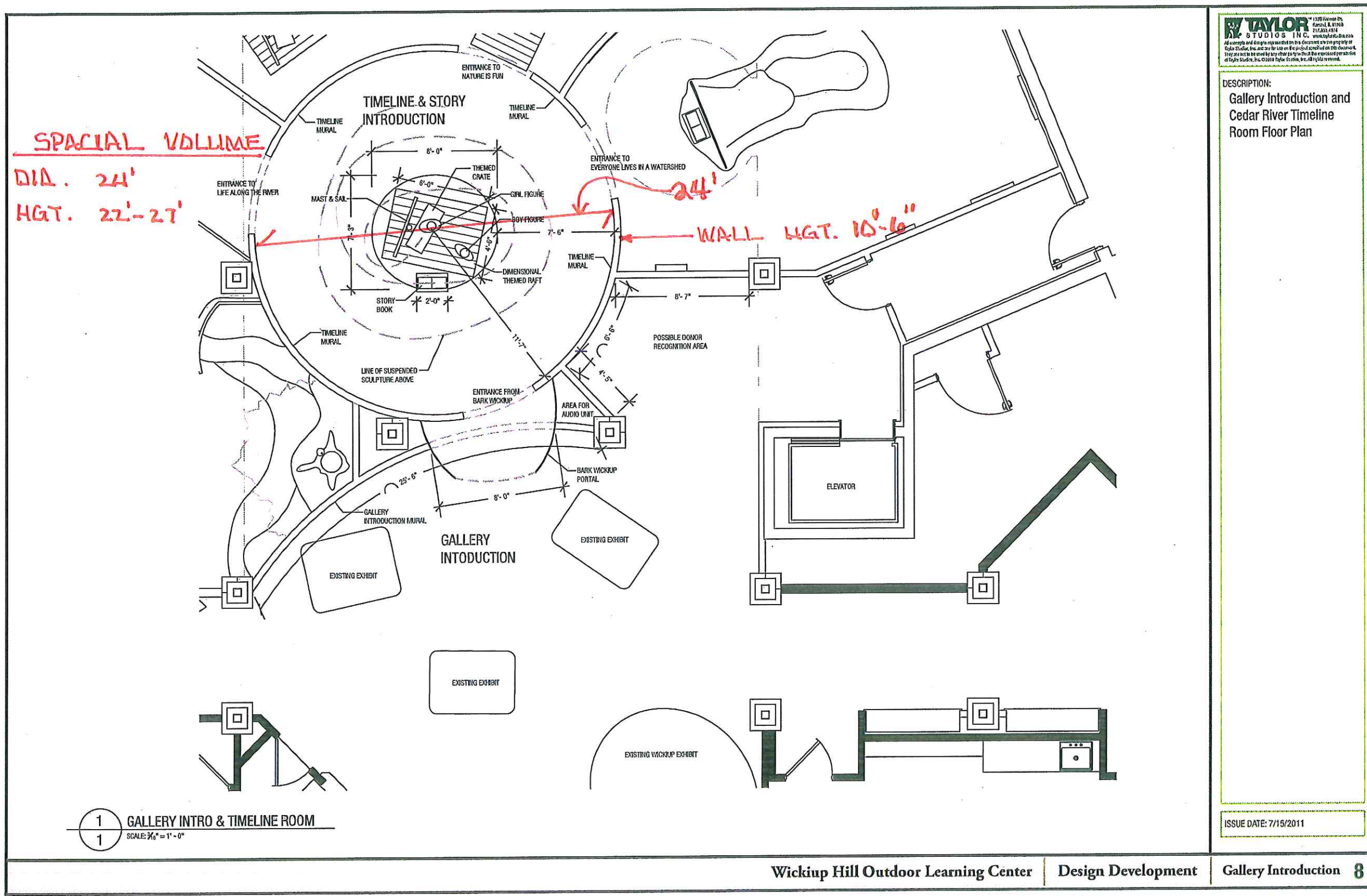

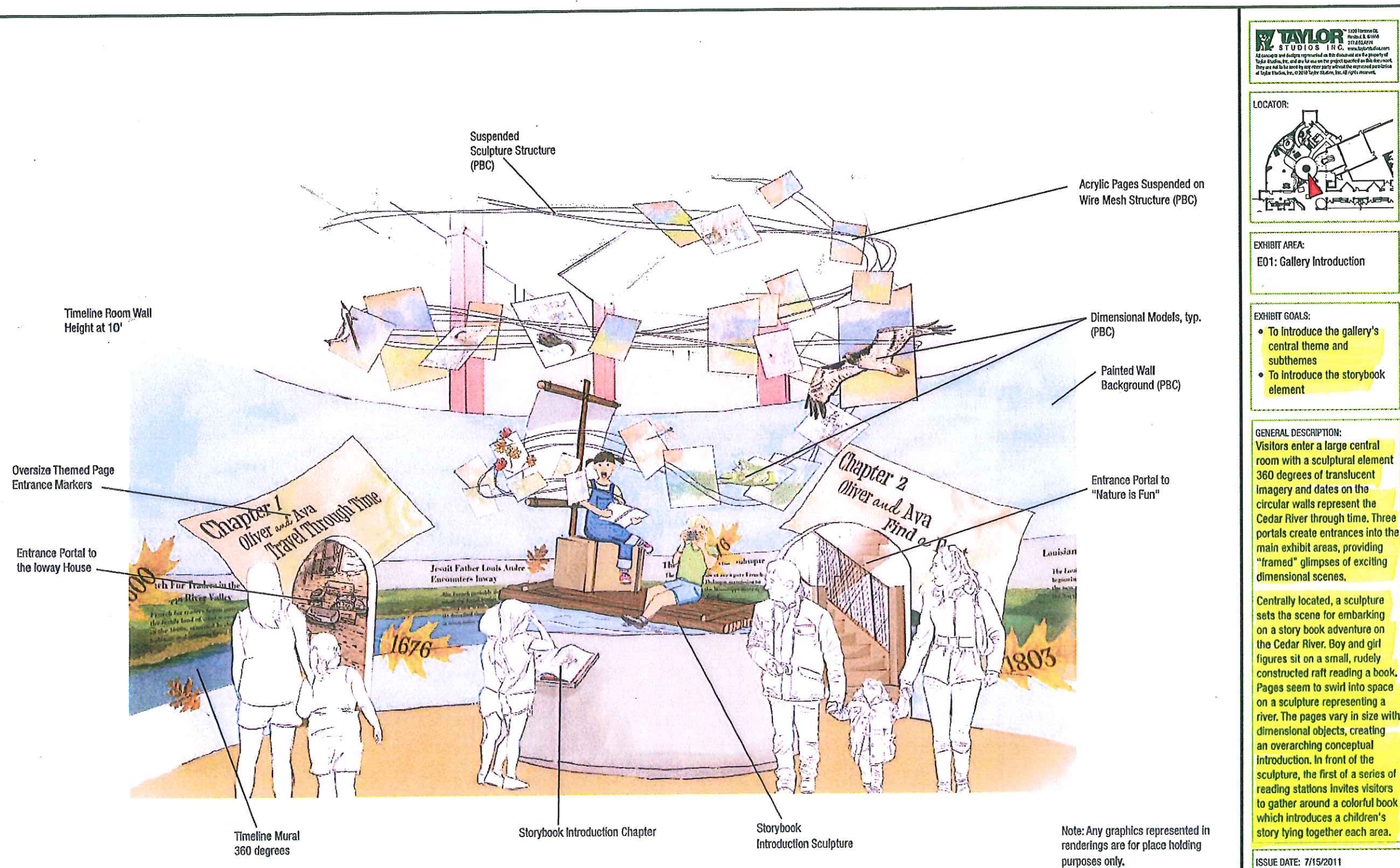

TAYLOR
STUDIOS, INC.
1100 TOWN DR.
SUITE 100
ST. LOUIS, MO 63104
www.taylorstudios.com
All concepts and designs represented on this document are the property of Taylor Studios, Inc. and are for use on the project specified on this document. They are not to be used by any other party without the expressed permission of Taylor Studios, Inc. ©2010 Taylor Studios, Inc. All rights reserved.

LOCATOR:

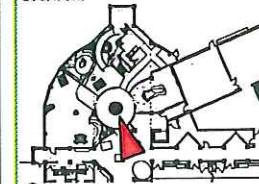

EXHIBIT AREA:

E01: Gallery Introduction

EXHIBIT GOALS:

- To introduce the gallery's central theme and subthemes
- To introduce the storybook element

GENERAL DESCRIPTION:

Visitors enter a large central room with a sculptural element 360 degrees of translucent imagery and dates on the circular walls represent the Cedar River through time. Three portals create entrances into the main exhibit areas, providing "framed" glimpses of exciting dimensional scenes.

Centrally located, a sculpture sets the scene for embarking on a story book adventure on the Cedar River. Boy and girl figures sit on a small, rudely constructed raft reading a book. Pages seem to swirl into space on a sculpture representing a river. The pages vary in size with dimensional objects, creating an overarching conceptual introduction. In front of the sculpture, the first of a series of reading stations invites visitors to gather around a colorful book which introduces a children's story tying together each area.

ISSUE DATE: 7/15/2011

TAYLOR
STUDIOS INC.
11201 Huron St.
Rochester, NY 14623
716.233.4474
www.taylorstudios.com
All concepts and designs represented on this drawing are the property of
Taylor Studios, Inc. and are for use on the project located on this document.
They are not to be used for any other project without the expressed permission
of Taylor Studios, Inc. © 2010 Taylor Studios, Inc. All rights reserved.

LOCATOR:

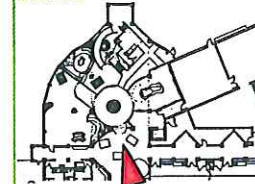

EXHIBIT AREA:

E01: Gallery Introduction

EXHIBIT GOALS:

- To create an inviting entrance to the main exhibit gallery
- To enhance current exhibit

GENERAL DESCRIPTION:

The existing scene in the lobby is enhanced and expanded to create an exciting entrance for visitors into the gallery.

Behind the existing Woodland figures, a large curved wall displays a river mural and brief text welcoming visitors to enter the gallery through a bark-covered wickiup.

The wickiup is a portal, taking them from the traditional lobby scene into the play-based exhibit galleries.

As visitors walk through the wickiup structure, they are immersed in ambient audio of a nearby river and people from the Woodland scene they have just encountered.

ISSUE DATE: 7/15/2011

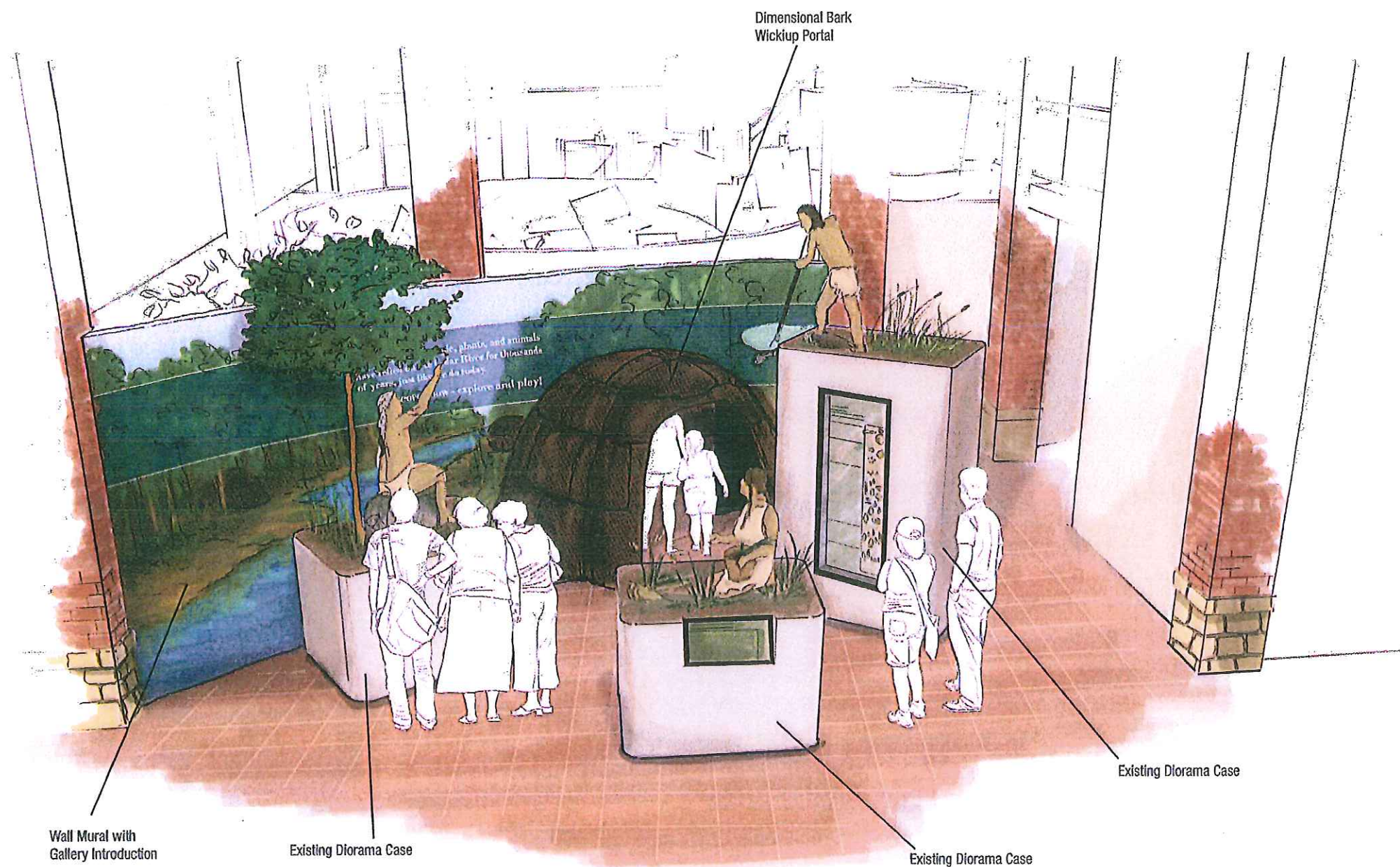

Note: Any graphics represented in renderings are for place holding purposes only.