

# Hāmākua Gallery

Floorplan = 750 square feet

Wall Space = 56 linear feet

Wall heights vary from 8 feet to 10 feet tall



view from atrium / lobby entrance

Wall on right is the first wall seen when entering the gallery.

There is space under the stairs that is commonly used for small artworks, video monitors, or installations.

The doorway on the right side of the picture is an Emergency Exit

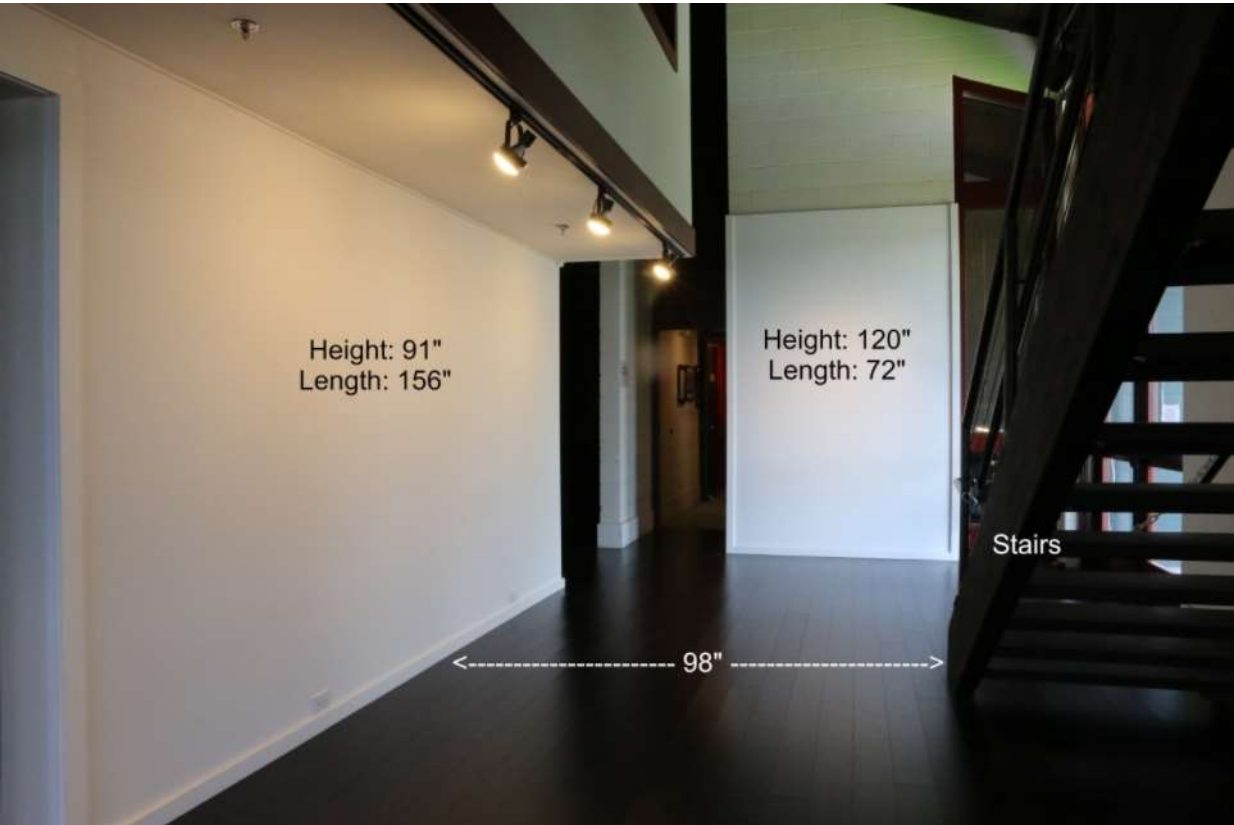

hallway adjacent to stairs



Under the Mezzanine looking back towards the Emergency Exit and atrium. Windows are UV protected.

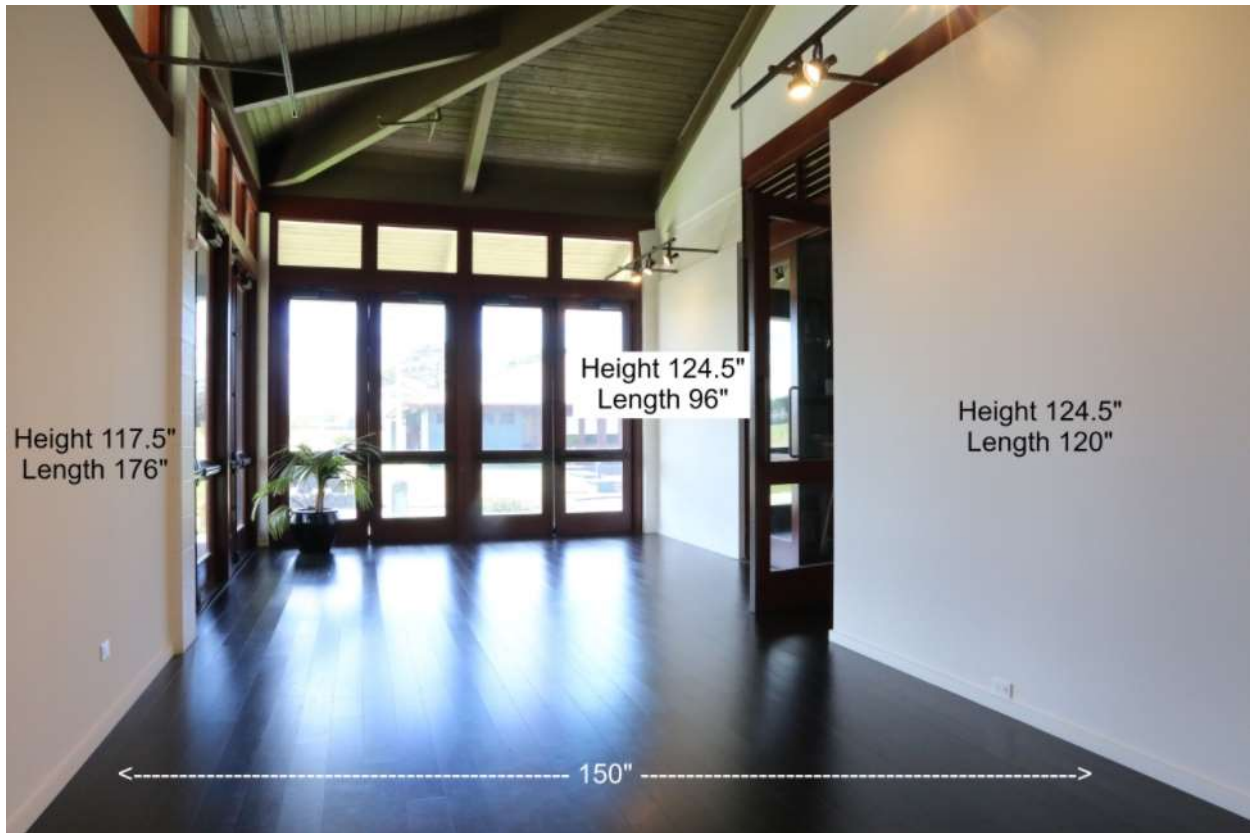

Doorway on the right is the main entrance to the gallery, just off the main lobby and bar area of the theater. The glass doors are only used in an emergency.



Staff entrance to the building (on the right), hallway to offices and backstage on the left. Stairs to mezzanine.

# Simperman Gallery

Floorplan: approximately 1150 square feet

Wall space: 79 linear feet

Wall height: 10 feet

Wall on right is 33 feet long and 10 feet tall. This wall cannot have any artwork that comes off the wall more than 8 inches. It is a designated Emergency Exit way.

There are two wooden benches available for use in this space, as well as pedestals, risers, and shelves of various dimensions.

View of wall space in the gallery







# offices

Glass Doors

G  
l  
a  
s  
s  
D  
o  
o  
r  
s

Entrance to Gallery

# theater

32' long by 10' high  
Plywood backed  
white walls

32' long by 10' high  
Plywood backed  
white walls

19' wide

6' wide, concrete block wall painted white

W  
i  
n  
d  
o  
w

8' wide

Hallways to side stage and bathrooms

## Mobile Wall



96" wide and 106" tall, this mobile wall unit can be placed in either gallery space.

