

Artwork Locations



Medical Respite Site Plan - Mantle Landscape Architecture

Possible Art Locations Map

Possible Art Locations

There are three possible locations for the two art pieces as shown in the Possible Art Locations Map. The finalist(s) will participate in the location decisions for each of the two art pieces. The two art installations can be displayed on a prominent inside wall of the Central Atrium or the outdoor Dining Courtyard or Entry Plaza.

1. Atrium

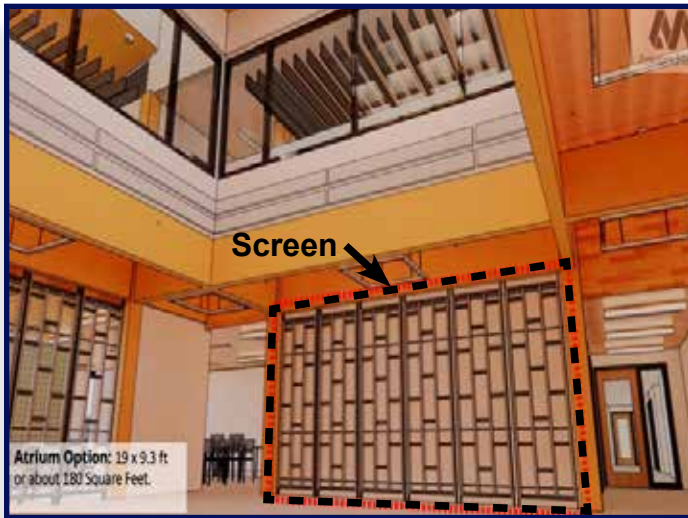

The Central Atrium is a two-story space with large wood framed skylights at the ceiling level. This beautiful indoor area is a central hub for clients with high activity and foot traffic. Common resident spaces overlook the atrium from the second level. The atrium is surrounded by exposed large wood columns. A large decorative wood screen in front of a wall is a possible art location. The screen can be incorporated or removed as part of the art. The wall is 19 feet x 9 feet, 3 inches, about 180 square feet. A painting, mural or suspended piece is feasible but may require a structural engineer to verify feasibility regarding weight/installation.

2. Dining Courtyard

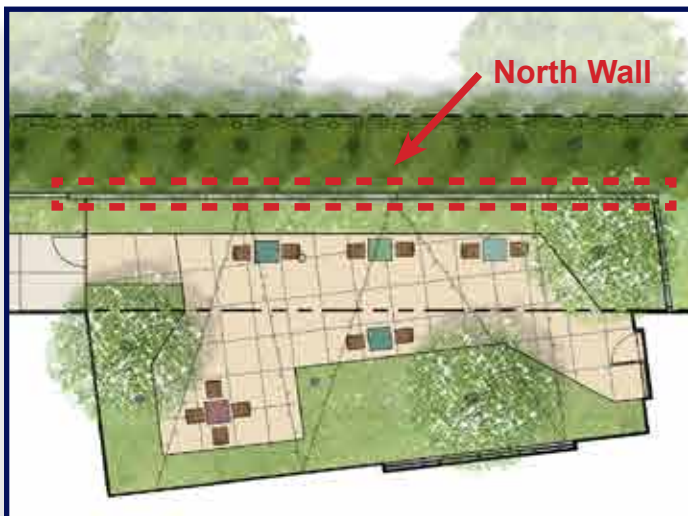

The outdoor Dining Courtyard is a small, shaded gathering space, visible from the indoor client dining area. The ground paving is concrete with movable furniture with an overhead “canopy” of string lights and three flowering dogwood trees. The north wall is 58 feet long which varies in height from 7’-5” to 10’-10” for a total of 490 SF. In addition to a painting or mural on the wall, a sculpture could be located in the 726 square feet of concrete paving in the courtyard.

3. Entry Plaza



The Entry Plaza is a tree-shaded shared street space welcoming clients and staff, featuring the main building entrance, seating, planters and sandblasted paving with a stenciled pattern of leaves. Art can be located: (1) under the building overhang below the windows next to the front door in a covered area of 7’-3”x 23’-8” or (2) in the 1,600 SF plaza area, as long as the art piece does not conflict with pedestrian and vehicle movement, drainage, planting, or the visibility of the front entrance from the driveway.