

FORD ROCKWELL BRANCH

The Ford Rockwell Branch Library first opened on Monday, March 29, 1976, replacing a small storefront branch that had been located at Central & Oliver. This branch was originally planned to be called the Edgemoor Park Branch. About a week before it opened, the Library Board of Directors voted to name the branch in honor of the retiring Ford Aldrich Rockwell (1907-1997), Wichita's head librarian from 1948-76. The Barbara Rockwell Children's Room inside the branch is named in honor of Mr. Rockwell's first wife, former children's librarian Barbara Hosmer Rockwell (1914-1971). When it opened, Rockwell was the largest public library branch in Wichita, and the first of those branches not located within a rented space.

The Rockwell branch now serves one of the largest service areas in the city, both in terms of size and population. Over one in five customers using branch library services in Wichita do so through the Rockwell branch. The primary focuses of the Rockwell branch are:

- Service for families and children
- Digital inclusion
- Lifelong learning
- Leisure services
- Improved accessibility with a new drive-thru

THE BUILDING

The Rockwell Branch is located in a mid-century neighborhood and was designed to reflect its surroundings. To support the branch's areas of focus an addition and remodel will create a large community meeting room, expanded children's area, a new teen space, and an expanded staff work area with a drive-thru.

The addition and renovation pay homage to the neighborhood aesthetic. Exterior brick is continued on to the new addition, with an emphasis on the iron spot brick in the original

building. Diamond-shaped windows are repeated, creating cozy nooks in the children's area. Inside, visitors are greeted by an original wood-clad vaulted ceiling that will be accented with new lighting and wood trim. The original fireplace will be honored with a new bookcase surround and comfortable furniture for lounging. Throughout the building, cozy, textural materials and rich walnut wood tones are used to create the feeling of an inviting living room. This cozy texture is carried into the children and teen areas, where bright colors are added to define and differentiate each space.



ROCKWELL - PROJECT DESCRIPTIONS

A summary of each project and budget is given below. Additional details are shown on the following pages.



1. Teen Window Graphics - \$6,500 Budget

Brightly-colored translucent window graphics define this area as separate from the rest of the library.

2. Artwork Above Fireplace - \$8,000 Budget

Wall art mounted above fireplace to enhance the warm, inviting "living room."

3. Children's Mural - \$4,350 Budget

Colorful children's wall mural

4. Community Meeting Room Artwork - \$6,150 Budget

An art installation with a nod to the region or community

5. Entry Lobby Artwork - \$2,400 Budget

A welcoming, engaging art installation.

6. Outdoor Sculpture - \$54,000 Budget

A dynamic, eye-catching sculpture.

The artwork commission budgets are inclusive of all costs and fees for the artist to execute the project from design through structural engineering, fabrication, site preparation, and transportation/delivery to the site. Installation will be coordinated with project construction team.

1. TEEN WINDOW GRAPHICS

ROCKWELL

For the first time the Rockwell branch will have a space just for teens. The two study rooms in the teen area are dedicated to them and need to convey that this is a unique space just for teens - grown ups keep out (seriously). The carpet and walls in the teen space will be deep blue to help define the space.

The two study rooms have full glazing in the doors with large sidelights for visual safety. The large glazed areas provide opportunity for translucent window graphics that further define the teen space with vibrant color and pattern. The window graphics must be translucent for visual safety.

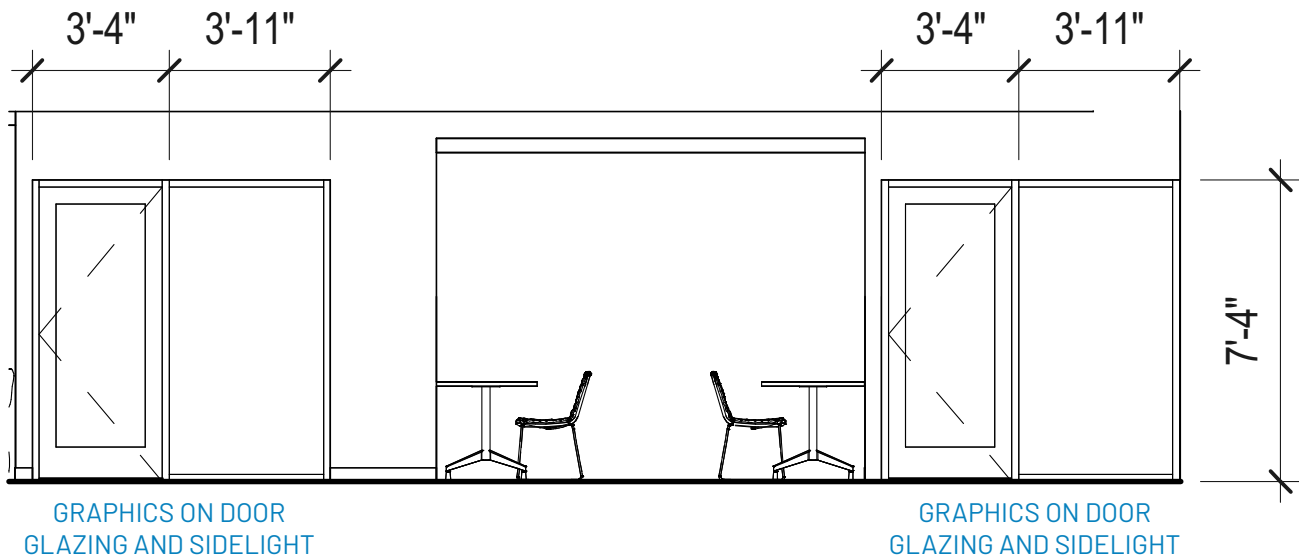

2. ARTWORK ABOVE FIREPLACE

ROCKWELL

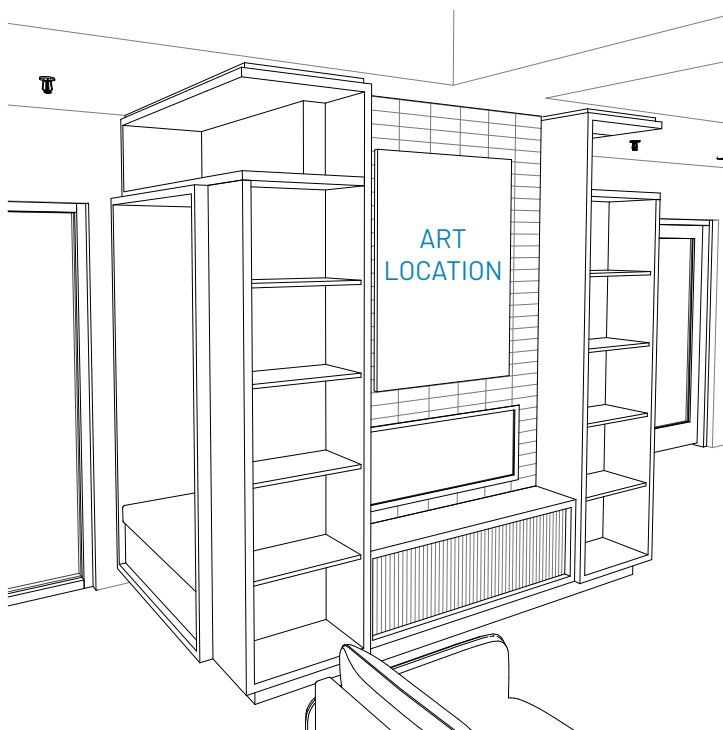

One of the first things visitors see when they enter the library, the fireplace and surrounding shelving and seating nooks set the tone for the "living room" of the library. The art piece should evoke warmth and nostalgia, adding to the inviting and serene atmosphere in the space.

The selection team is open to different mediums for this art piece. Creative interpretations that will complement and enhance the charm of the library's interior are welcome.

Iron spot brick will provide the background, and the surrounding shelves will be walnut wood.

The maximum space available for this piece measures 3'-0" wide x 4'-0" high.

3. CHILDREN'S MURAL

ROCKWELL

The children's area will be an energetic, engaging space to capture young readers. Along the north wall, colorful nooks shaped like houses create cozy, whimsical spots for young readers to discover a new favorite book. There is an opportunity along the east wall, between windows and above the bookcases, for a cheerful and engaging mural to draw children into the space. The mural should complement the playful interior and spark the imagination, transforming the space into a whimsical haven where stories come to life.

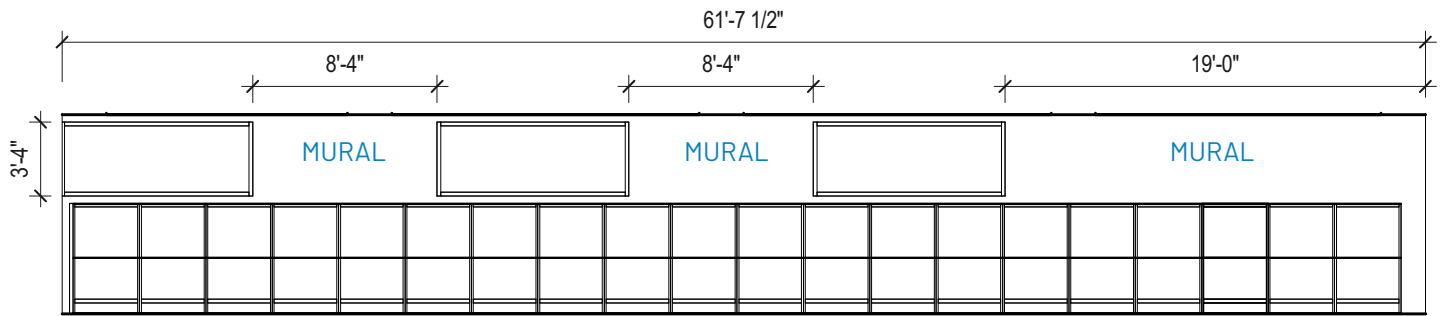

4. COMMUNITY MEETING ROOM ARTWORK

ROCKWELL

The renovated branch will have a community meeting room double the size of the previous room. This multi-purpose space will greatly expand the programming the library can offer toward the focus of lifelong learning, as well as be available to the public in an area of Wichita with limited available public gathering spaces.

The area for this artwork is a large wall recess, which is dimensioned below. This piece can be a single large work or a series of smaller, cohesive pieces. The piece or pieces in this space should embody a sense of community and innovation, contributing to an inspiring space where community engagement and lifelong learning flourish.

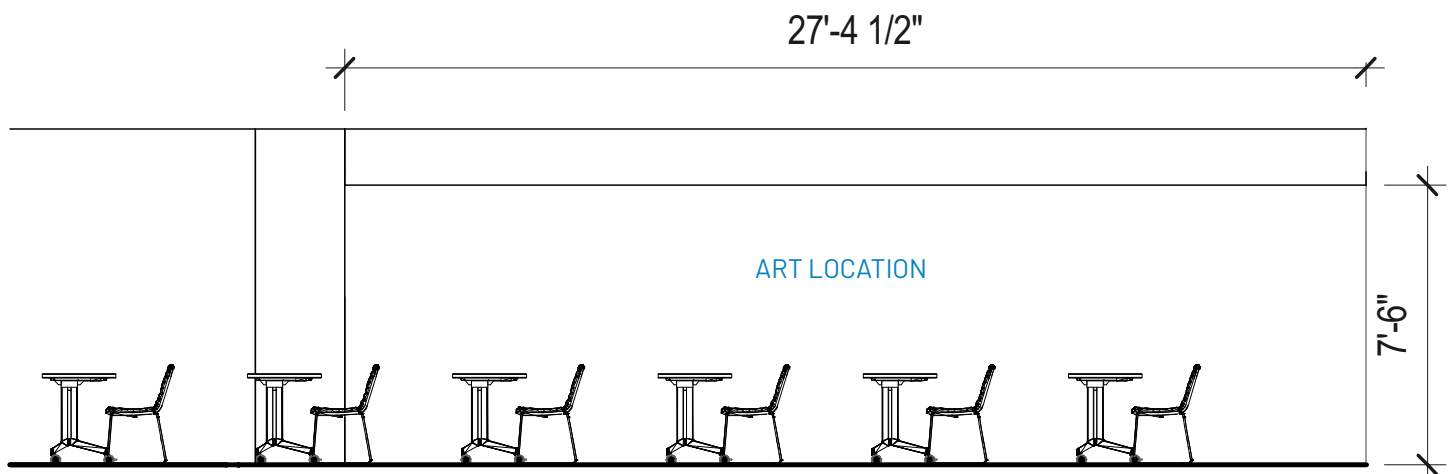

5. ENTRY LOBBY ARTWORK

ROCKWELL

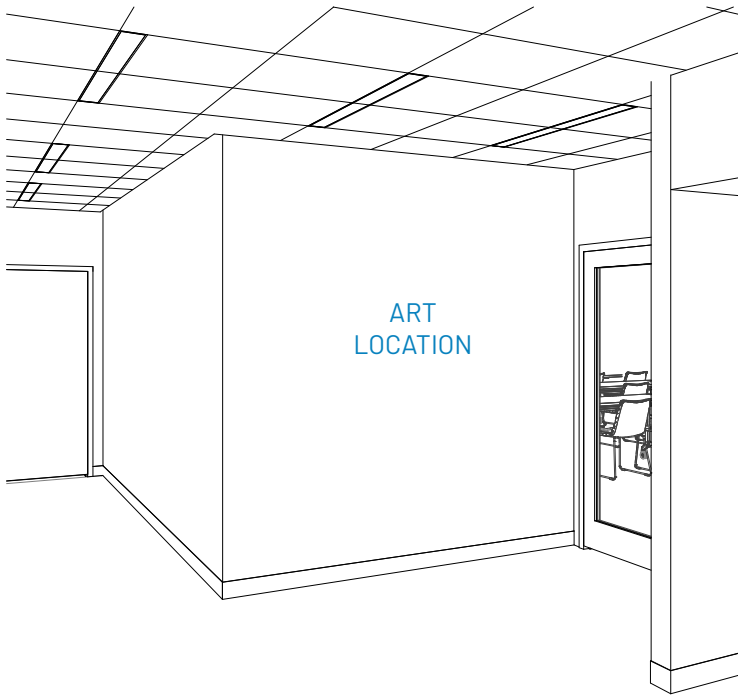

The art in this location will be seen by patrons coming to the new large community meeting room. This piece should be unique and captivating, welcoming the community into the space. Different mediums will be considered, but the piece must be relatively flat as it will be installed on a wall where the meeting room doors will open against.

This piece should reflect the spirit of the neighborhood and celebrate the unique and diverse cultures within Rockwell's services area. This particular space in the library does not have a lot of color in the interior materials; the floors will be a vein cut travertine-look porcelain tile and the walls will be neutral paint. A piece that is rich in texture, color, or material would bring a lot to this space.

The wall where the piece will be mounted measures 8'-6" wide X 9'-0" high.

6. OUTDOOR SCULPTURE

ROCKWELL

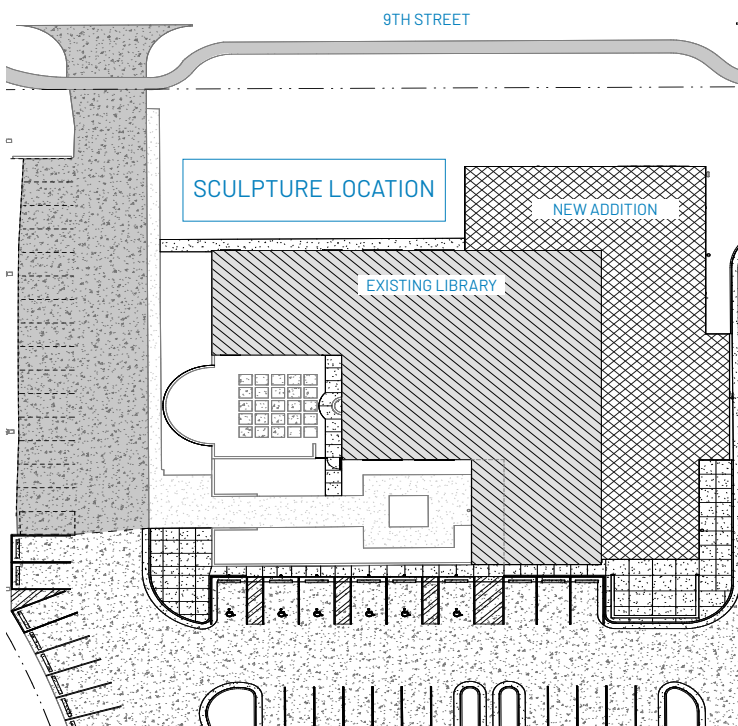

The site-specific outdoor sculpture should be appropriate to the character of the neighborhood and further the sense of place, inspire, create dialogue, and enhance the experience of library visitors. The artwork should respond to the site conditions and context, including scale of work, materiality, site-lines, and adjacent residential and park functions.

The space available for the sculpture measures approximately 36' x 56'.

All structural footings and engineering to be included in artist's scope.

INTERIOR AND EXTERIOR MATERIAL PALETTE

ROCKWELL & EXTERIOR MATERIALS

PAIN T

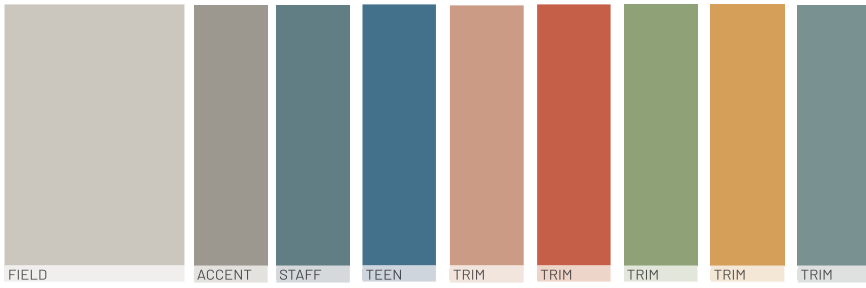

WALL TILE

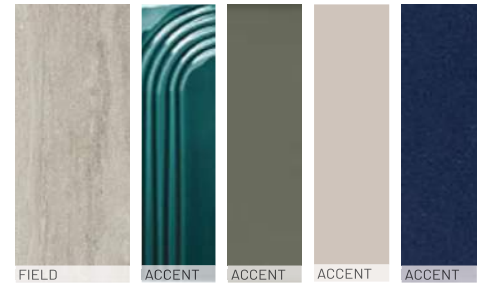

FLOORING



CASEWORK

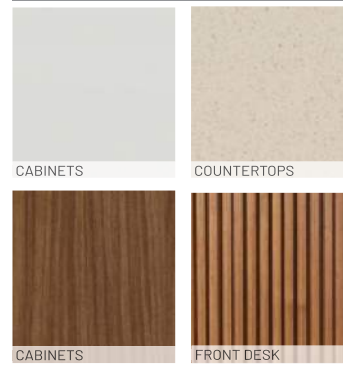

EXTERIOR

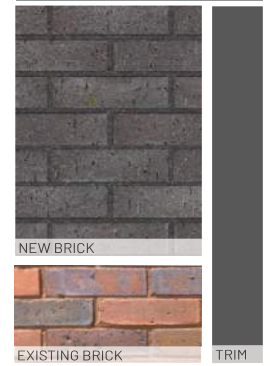

MAYA ANGELOU BRANCH

The Maya Angelou Northeast Branch Library was dedicated on Friday, December 20, 1996 to a packed crowd with Maya Angelou (1928-2014) in attendance. Angelou was an author, poet, professor, civil rights activist, playwright, actress, director, and producer. "I never knew a library named for anyone who was alive," she commented. "All the libraries that kept me alive and saved my life and then helped me extend my life, were always named for whole towns or countries or states or people who were dead." At the time, the Wichita City Council had a policy against naming public buildings after living people, but made an exception for Angelou.

The primary focuses of the Maya Angelou Branch are:

- Early literacy and school readiness
- Digital inclusion
- Expanding access to works by African-American authors and creators.
- Expanding neighborhood programming related to cultural celebration.

THE BUILDING

In 2021, a mural featuring Maya Angelou by artist Priscella Brown in partnership with Real Men Real Heroes was added to the 21st Street-facing side of the building. The mural features vibrant-eye catching colors and a quote by Maya Angelou.

"We all should know that diversity makes for a rich tapestry and we must understand that all the threads of the tapestry are equal in value no matter what their color."

The current project will add a sun room to the west side of the branch for the community to gather and enjoy the library offerings. The interior remodel will focus on the word "tapestry" from Maya Angelou's quote, bringing in warm, textural finishes and upholstery. The interior material palette will continue the colors from the mural inside, creating a layered, energetic, and cohesive library branch.



ANGELOU - PROJECT DESCRIPTION

A summary of the project and budget is given below. Additional details are shown on the following pages.

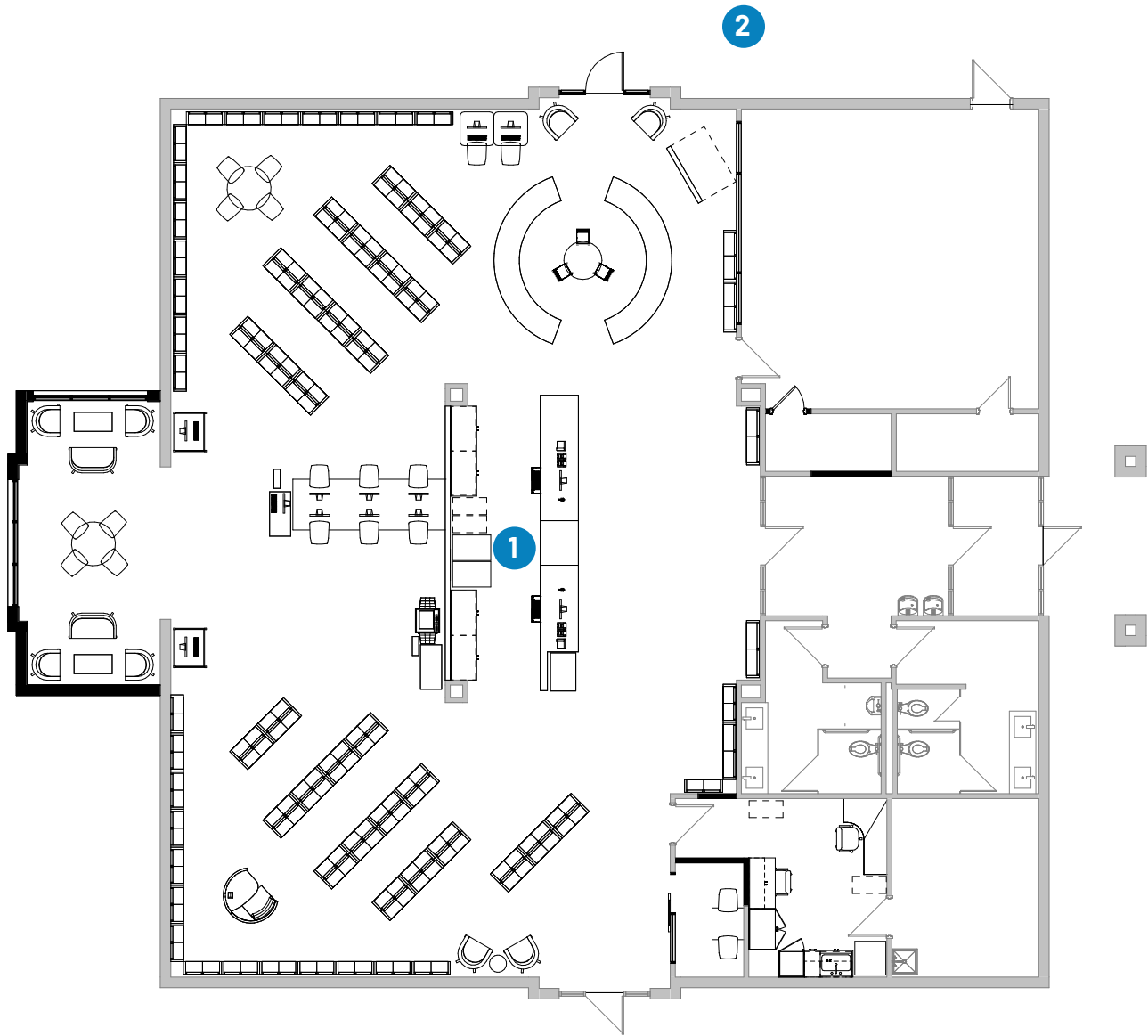

1. Front Desk Glass Graphics - \$6,600 Budget

Brightly-colored translucent window graphics for glass dividers inspired by Maya Angelou's work.

2. Exterior Signage - \$49,000 Budget

Street signage in the colors of the Divine Nine.

The artwork commission budget is inclusive of all costs and fees for the artist to execute the projects from design through structural engineering, fabrication, site preparation, and transportation/delivery to the site. Installation will be coordinated with project construction team.

1. FRONT DESK GLASS GRAPHICS

ANGELOU

The new service desk will be the first thing visitors see when they enter the remodeled Angelou library. The graphics on the glass should be inspired by the work, life, and activism of Maya Angelou, and be a celebration of African-American Culture. There are already several images of Maya Angelou throughout the branch, no additional portraits will be considered. The intent is for the mural to be very colorful, possible color palette inspiration is shown below but is not required.

Separating the front desk from the computer access behind will be a 4-foot high knee wall. Two glass panels, each measuring 8'-0" wide x 5'-6" tall, will extend from the top of the knee wall to the ceiling above. These glass panels create an opportunity for colorful, joyful graphics that will be visible from all public locations in the library, and will be back-lit by windows in the new sun room. The graphics must be translucent for visual security behind the desk.

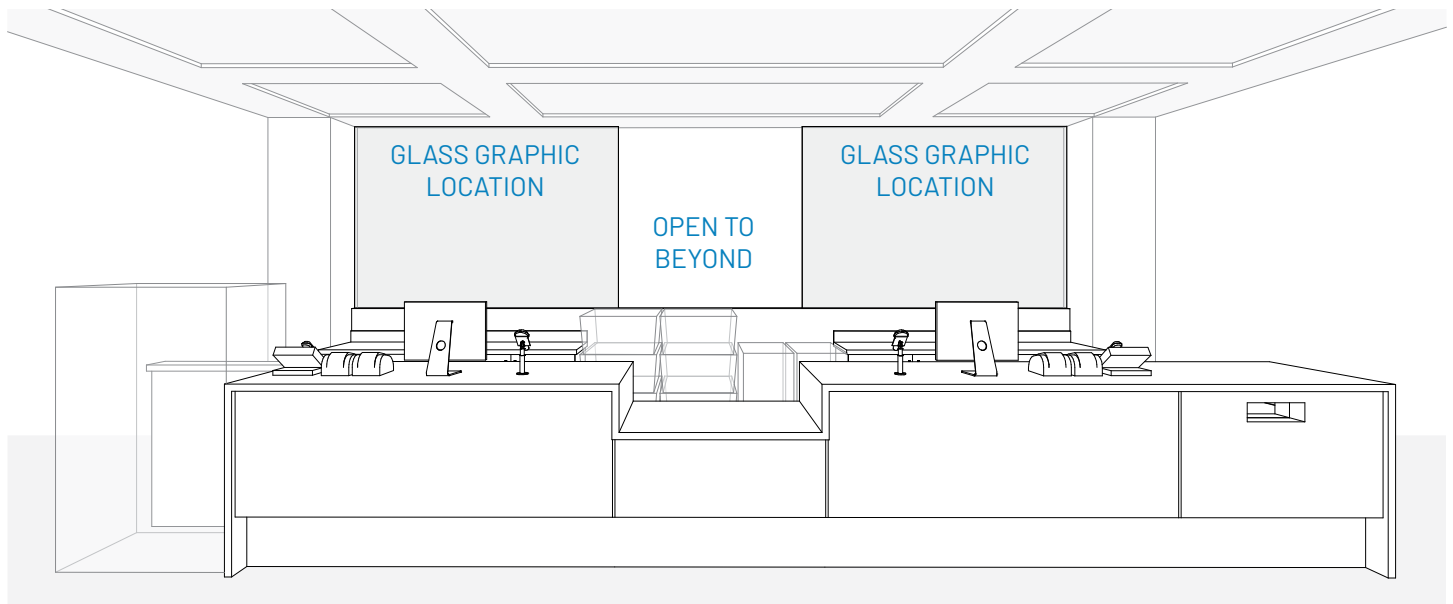

2. EXTERIOR SIGNAGE

ANGELOU



The existing library building lacks visibility from 21st Street to the north, and visitors have a hard time finding the branch. The addition of the Maya Angelou mural in 2021 gave additional identity and color to the building, and further signage is needed to communicate to the building function to visitors. The land on the north side of the building will have a new community garden as part of the current remodel and addition.

The new exterior sign should be comprised of 36" tall individual, multi-dimensional letters saying "MAYA ANGELOU LIBRARY" and be in the colors of the Divine Nine. Artist input on the letter material will be accepted; the material and colors must be durable and withstand exterior elements. All structural footings and engineering to be included in artist's scope.



INTERIOR MATERIAL PALETTE

ANGELOU

FLOORING



PAINT



CASEWORK

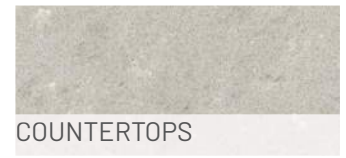

MURAL - POSSIBLE COLOR INSPIRATION

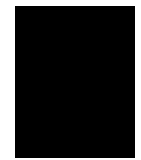
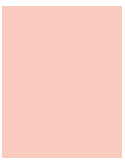

LIONEL D. ALFORD BRANCH

The Lionel D. Alford Regional Branch Library first opened its doors on April 5, 2003. The branch was dedicated in memory of Lionel D. Alford (1925-2000) for his community vision, involvement and for his outstanding service to the citizens of the community. Mr. Alford, a retired senior vice president at Boeing, was credited for leading Boeing Wichita's transformation during the 1980s from the brink of closure into the state's largest private employer and key facility to the Boeing Company's worldwide operation.

The primary focuses for the Alford Branch are:

- Early literacy and school readiness
- K-12 student achievement
- Workforce development

THE BUILDING

The building's design, from the distinctive wing-shaped roof to its support beams, was inspired by Mr. Alford's background in the aircraft industry. The children's area is named in honor of Richard Rademacher (1937-2020), Wichita's Director of Libraries from 1976-2000.

The interior remodel will increase the number of meeting and study rooms available, a critical element to facilitate the

branch's focus areas. New lighting throughout will provide much-needed and efficient ambient and task lighting for patrons and staff.

The interior material palette will be a continuation of the exterior aviation theme with tonal blues and greens complimented by warm golden tones, with wood and ochre textures.



ALFORD- PROJECT DESCRIPTION

A summary of the project and budget is given below. Additional details are shown on the following pages.

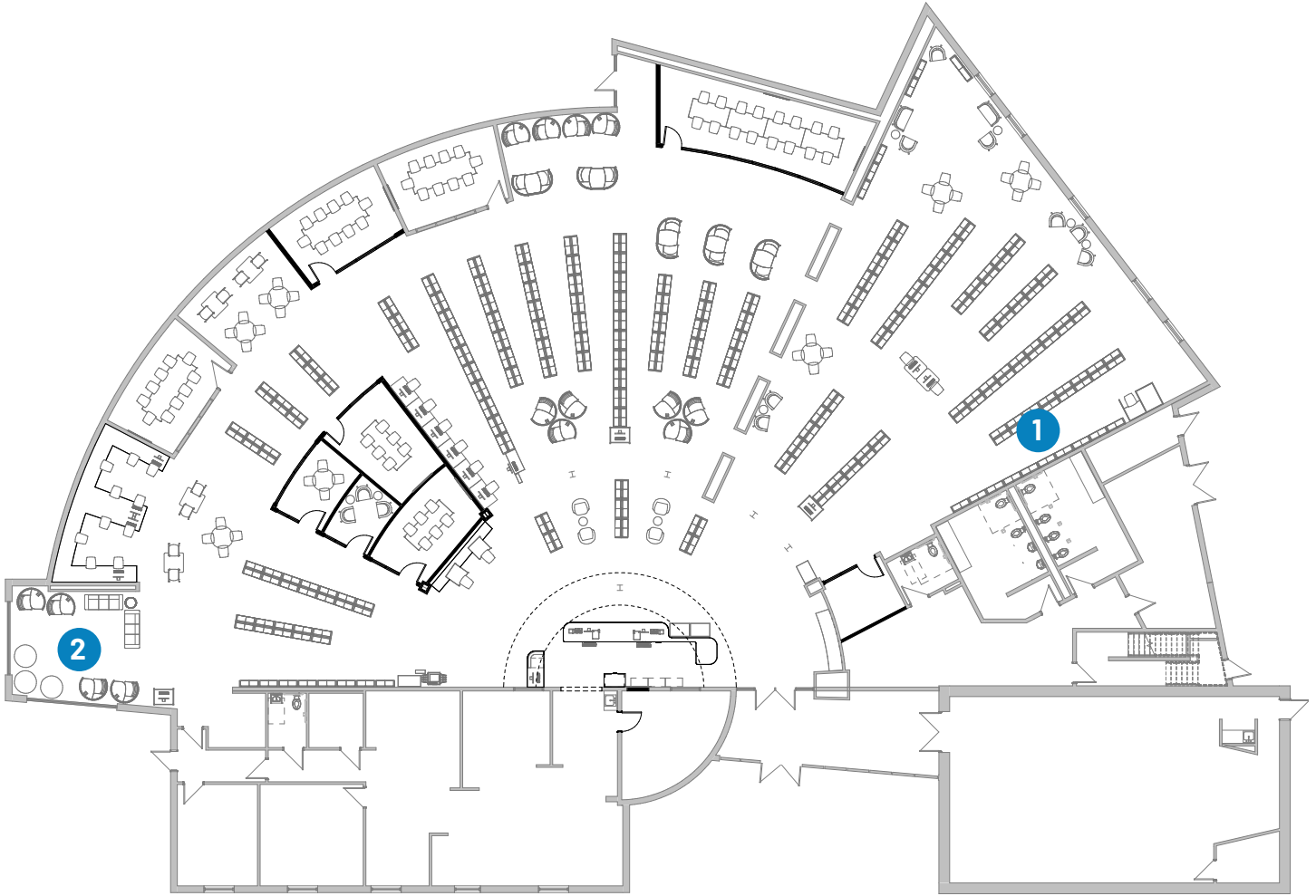

1. Children's Mural - \$9,975 Budget
Colorful children's wall mural

2. Teen Art Element - \$16,000 Budget
Colorful 3D element to define teen space

The artwork commission budgets are inclusive of all costs and fees for the artist to execute the project from design through structural engineering, fabrication, site preparation, and transportation/delivery to the site. Installation will be coordinated with project construction team.

1. CHILDREN'S MURAL

ALFORD

One of the primary initiatives for the Alford branch is to contribute to the collective impact of organizations who know that entering school ready to learn and graduating on time lead to success in work and life. Expansion of children's program has been identified as the most important program change for the branch.

There is an opportunity for a large, colorful, and engaging wall mural above the bookshelves in the children's area that inspires curiosity and a love of learning in young learners. The mural can be one large piece, or a series of cohesive pieces over the length of the wall. With the expansion of children's programming, this mural has the opportunity to reach thousands of children annually.

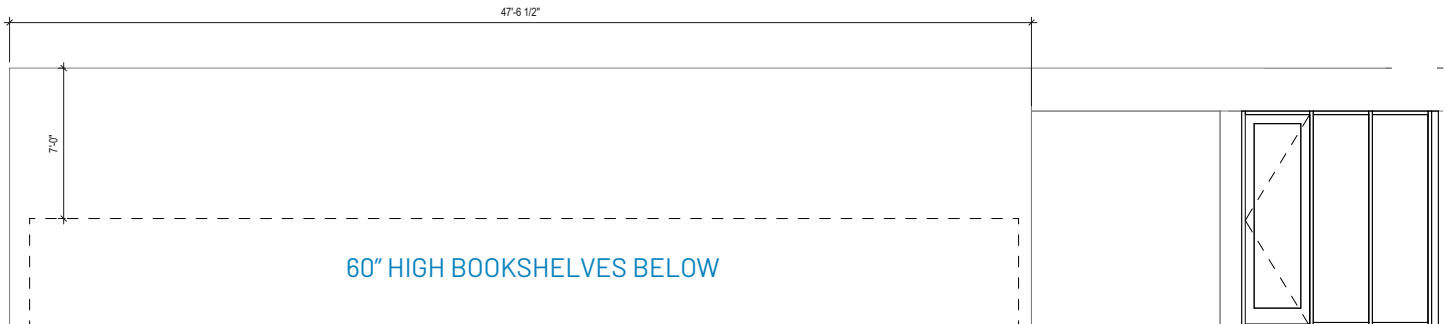

2. TEEN ART ELEMENT

ALFORD



Teens will have a new light-filled space just for them in the remodeled Alford branch. Drawing teens to the branch and this space will help support the branch's focus on K-12 student achievement. This space is currently one of the most popular spaces for people of all ages to lounge, so the new space needs to signify the change to a teens only space. Interior material transitions and comfy furniture will help define the space. A large art element will further define the space.

The art element should be 3-dimensional, and can either stand off of the wall(s) or be suspended from the ceiling. The element should coordinate with the remodeled color palette, but additional colors are welcome.

The room measures approximately 19' x 17". The available walls measure approximately 14'W x 16'H, and 9'W x 16'H and are constructed out of metal studs and gyp board. The existing roof framing can support an art piece up to 5,000lbs. Additional structural engineering will be required to verify once actual art piece is conceptualized. Any required structural engineering, additional framing, or wall reinforcing to be included in artist's scope.

INTERIOR MATERIAL PALETTE

ALFORD

PAINT



FIELD



ACCENT



ACCENT



ACCENT



ACCENT

WALLCOVERING



ACCENT WALLCOVERING

FLOORING



FIELD



ACCENT



ACCENT



MEETING



STAFF



TEEN

CASEWORK



FRONT DESK



COUNTERTOPS



EXISTING STACKS