

The Magic Silver Show 2025

The Elena Diane Currís Juried Photomedia Exhibition

The Clara M. Eagle Gallery is now accepting entries for the 2025 *The Magic Silver Show: The Elena Diane Currís Juried Photomedia Exhibition*. The *Magic Silver Show* began in the mid 1970's as a juried exhibition designed to encourage, foster understanding, and reward those involved in photographic media. This exhibition will present a survey of contemporary photo media in all aspects and genres. Accepted entries will be on view in The Clara M. Eagle Gallery at Murray State University from August 25 - October 13, 2025.

Example installation views of The Clara M. Eagle Gallery exhibition space.



SHIP TO:

The Magic Silver Show 2025
The Clara. M Eagle Gallery
Murray State University
604 Fine Arts Building
Murray, KY 42071

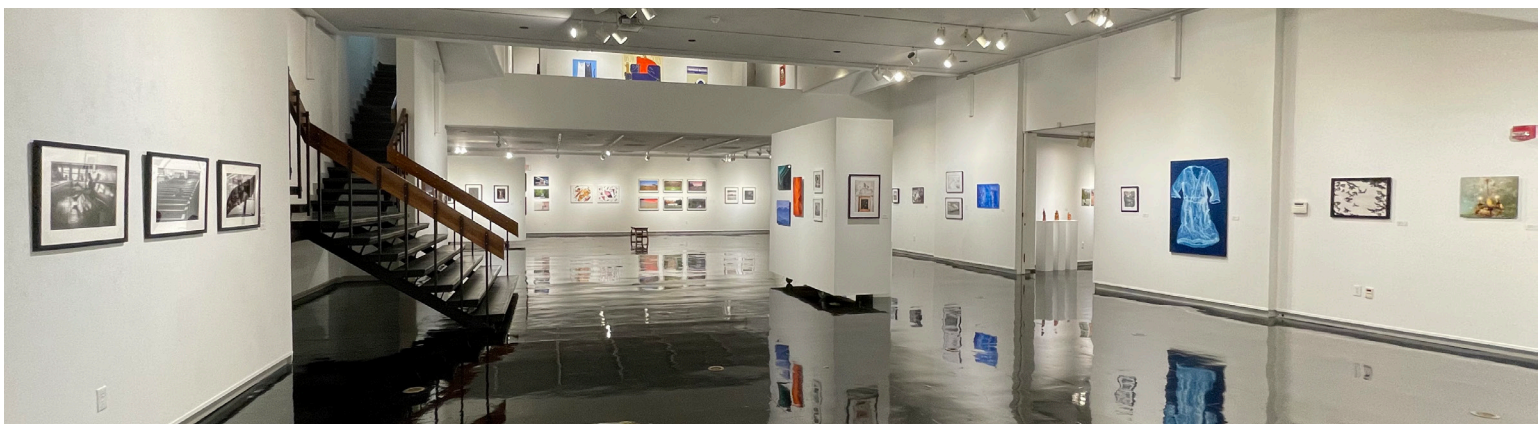
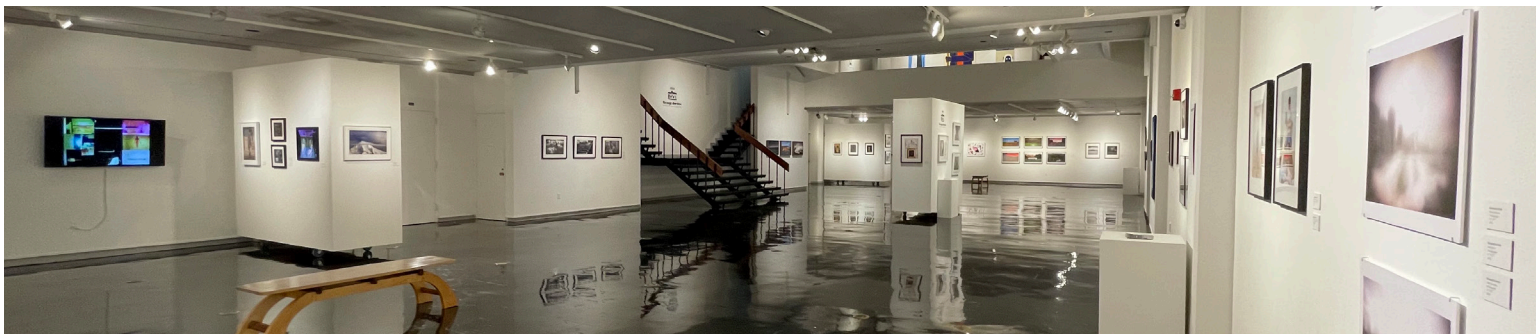

For additional information contact:

T. Michael Martin, Director of University Galleries | 270.809.3052 | msu.eaglegallery@murraystate.edu | www.murraystate.edu/artgallery

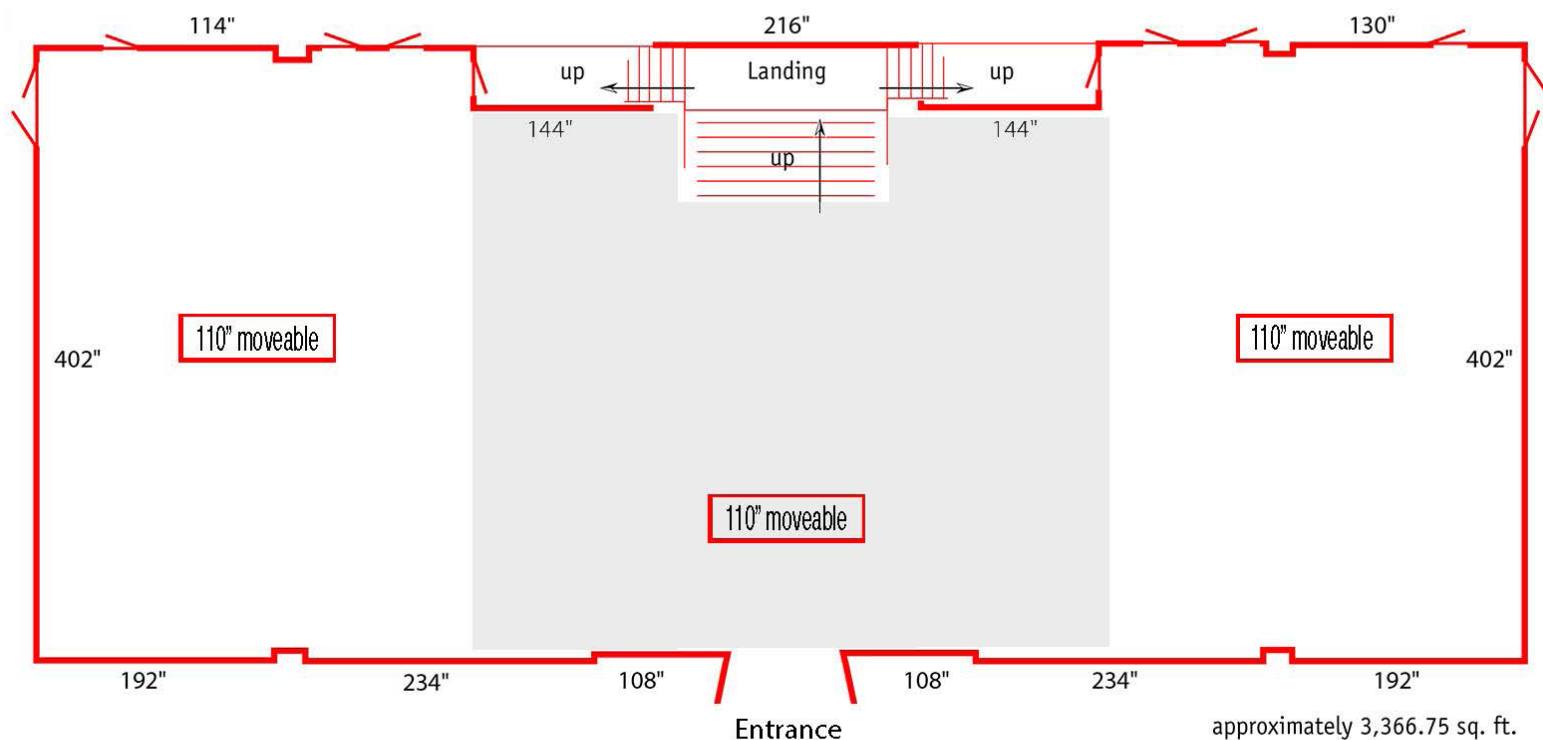

Clara M. Eagle
Main Gallery
Murray State University
Sixth Floor Fine Arts Building
Murray, KY 42071

13' + high ceiling
other areas are approx. 10' high

The 110" moveable walls are 34" wide.

Eligibility

Entry is open to regional, national, and international artists 18 years or older working in all photomedia including, but not limited to, traditional black and white or color photography, experimental or non-traditional light sensitive processes, digital media, film, video and moving image. Accepted entries must be original, completed within the last 5 years, and not previously exhibited in The Clara M. Eagle Gallery.

Calendar

June 26, 2025 Entry submission deadline, all entries must be submitted for jurying process.

July 9-11, 2025 Notification of accepted entries emailed to artists.

July 30, 2025 Works must be shipped or hand delivered to the gallery by 4PM on this date.

August 25, 2025 *The Magic Silver Show: The Elena Diane Curris Juried Photography Exhibition* opens.

October 22-28, 2025 Works will be shipped/returned during this time.

A juror talk and reception date/time will be announced at a later date.

The 2025 *The Magic Silver Show: The Elena Diane Curris Juried Photomedia Exhibition* will be on-view from August 25 - October 13, 2025 in The Clara M. Eagle Gallery at Murray State University.

For additional information contact:

T. Michael Martin, Director of University Galleries | 270.809.3052 | msu.eaglegallery@murraystate.edu | www.murraystate.edu/artgallery