

Bob Crane Community Center Public Art Installation Site Location

3200 Tremont Road, Upper Arlington, OH 43221



PROJECT BUDGET: \$100,000

PROJECT GOALS:

- Install a sculptural or 3D artwork that gives the Bob Crane Community Center a strong visual identity and sense of place.
- Define a gathering space at the Bob Crane Community Center by installing artwork that fosters a strong sense of community.
- Reflect the character, values, and aspirations of the Upper Arlington community. The design should thoughtfully reflect the Bob Crane Community Center as a hub for health, wellness and connection.



Site Location – Bob Crane Community Center



Located at 3200 Tremont Road in the heart of the Kingsdale Mixed-Use Project, the Bob Crane Community Center is Upper Arlington's new hub for health, wellness, and connection. Spanning over 165,000 square feet across five floors and a mezzanine level, the facility offers something for every resident—from an indoor pool, playground, and two gymnasiums, to a walking/running track, café, fitness studios, and e-sports room. Dedicated spaces include an event center, meeting rooms, program classrooms, and an art gallery, as well as amenities like Child Watch services and locker rooms. The second and third floors house 33,400 square feet leased by The Ohio State University Wexner Medical Center, featuring The James Survivorship Center, Orthopedic Physical Therapy, and Integrative Medicine services. A rooftop solar array supports the City's sustainability goals, offsetting energy costs by over \$50,000 annually.



Site Location – Bob Crane Community Center Main Floor Lobby

Starting point for fun, fitness, and family-friendly amenities. This area hosts the Core Café and is adjacent to the Welcome Desk, Fitness Center, indoor play area, and Party Room. Opportunity for hanging installation or sculptural display.

LOBBY

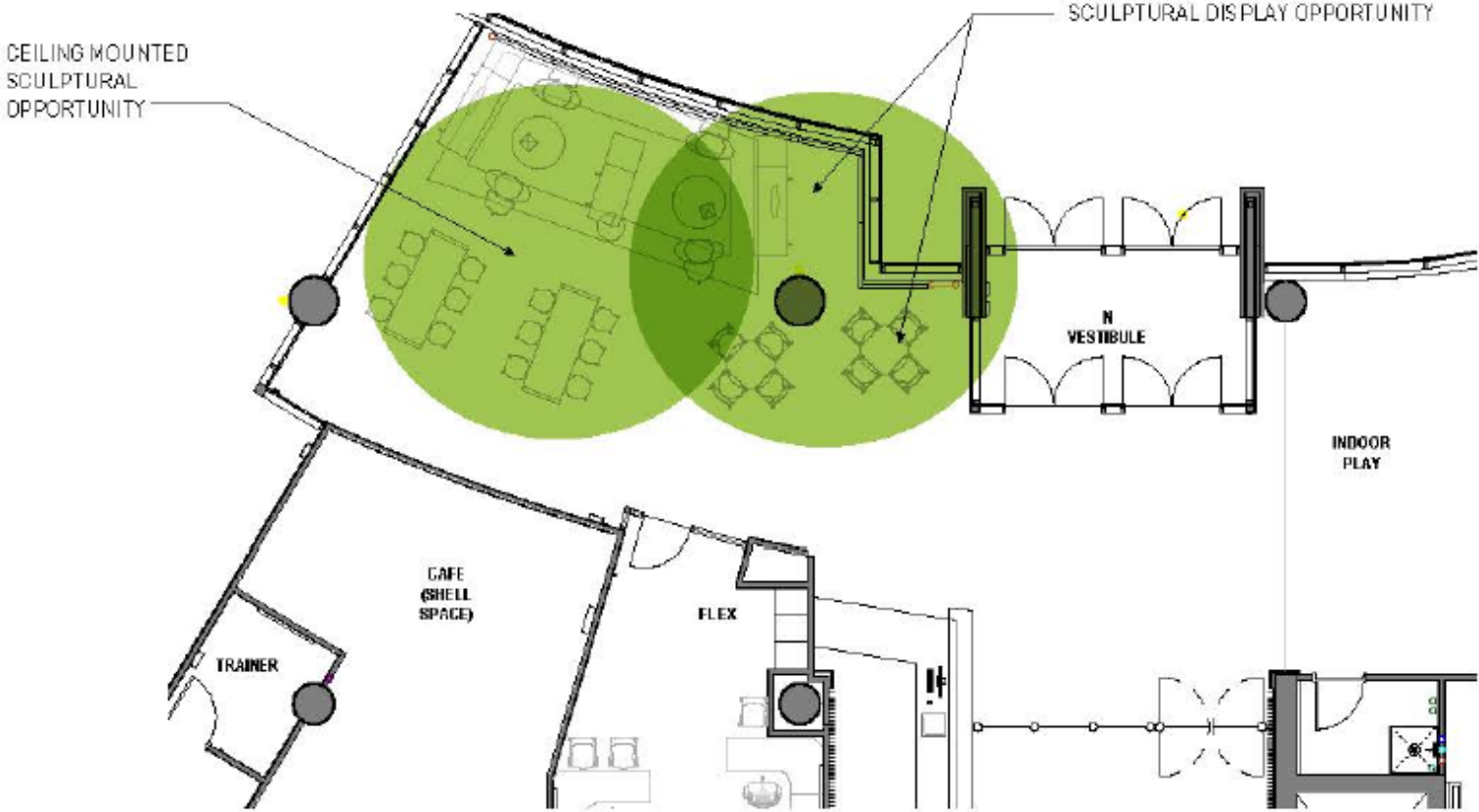

Site Location – Bob Crane Community Center Main Floor Lobby

