

Schedule:

Project Summary:

- Create a premier environmental education and play experience including outdoor classroom, climbing platforms, rock sculptures, sand play and supervised camping area for underprivileged urban children
- Construct a signature concrete jetty and stone amphitheater and fire pit along the river with signage interpreting the history and ecology of the site
- Build a system of bio-retention swales and basins to improve water quality
- Enhance over 3,000 LF of the SPR Trail with expanded concrete bike path and soft surface pedestrian trail
- Bank stabilization, removal of invasive species and restoration of emergent, riparian and upland vegetation

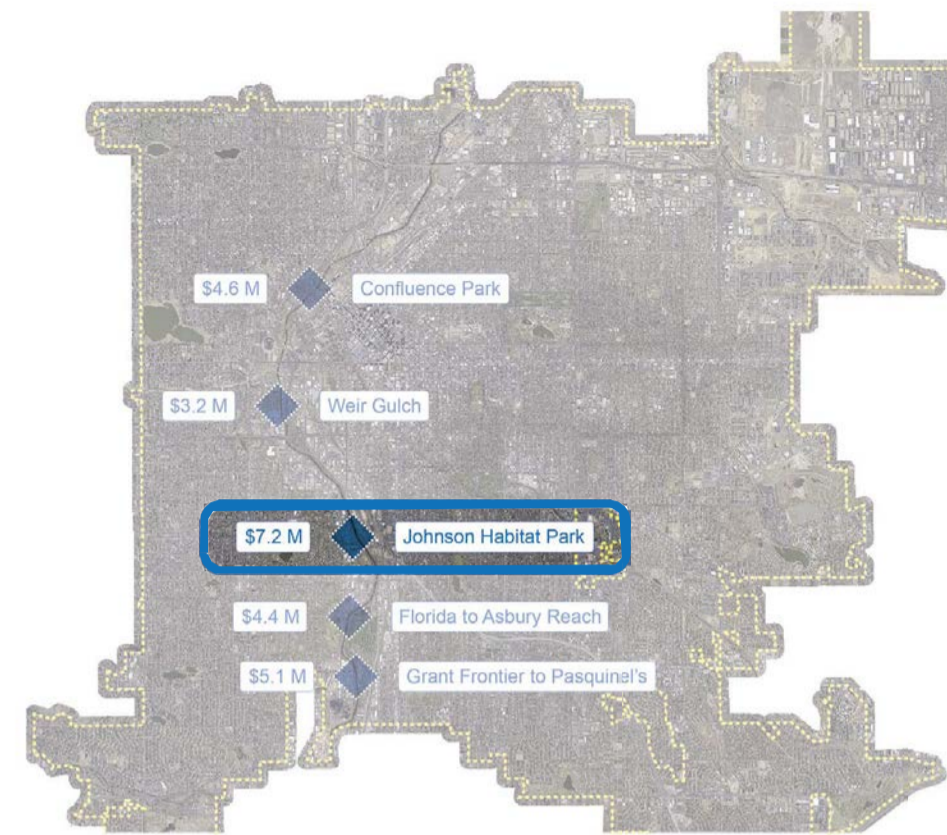

Key Map



Interpretive Overlook

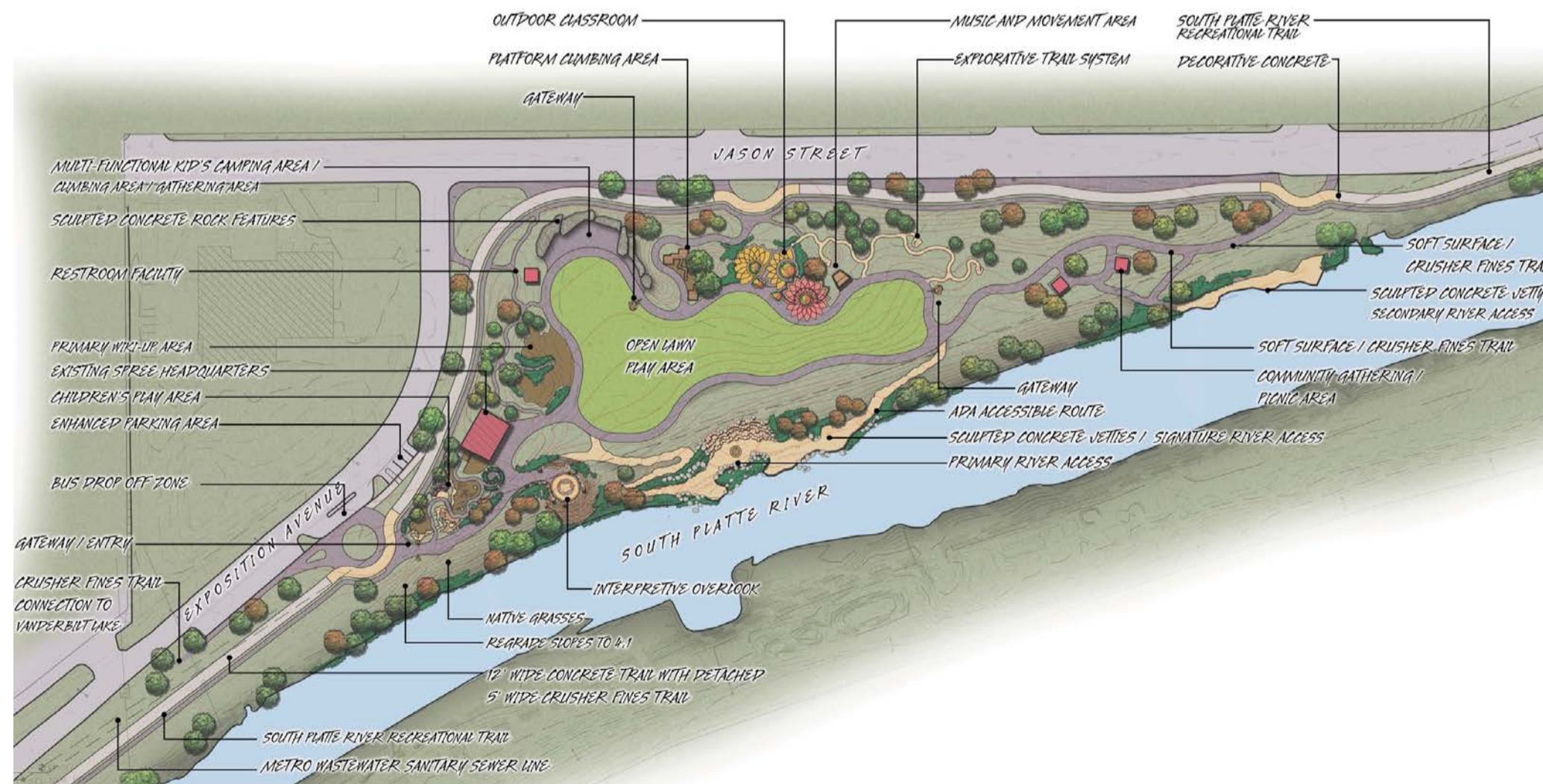

Illustrative Plan



Concrete Jetty and Stone Amphitheater and Fire Pit

F

Project Summary:

- Redesign Grant Frontier as an active 'River Park' with secondary channel and island, flood terrace walls, habitat benches, 'Montana City' - historic interpretative feature and environmental play area
- Redesign Pasquinel's Landing as a passive 'River Park' with extensive riparian bench, walking and hiking trails, riverfront lawn terrace with boulder seat wall, and adult fitness zone
- Construct 3,000 LF of new SPR Trail with expanded concrete bike path, 4,000 LF of soft surface pedestrian trail, new river access points for fishing and boating and improved underpass at Evans
- Bank stabilization, removal of invasive species and restoration of emergent, riparian and upland vegetation

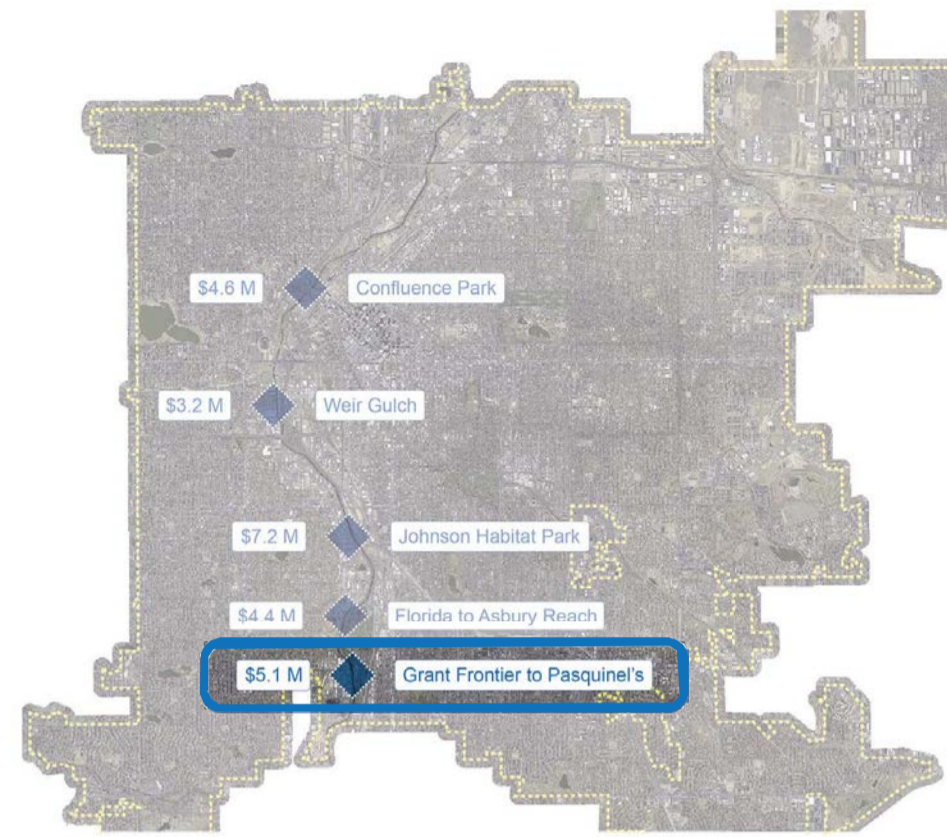

Key Map



Pasquinel's Landing Park Illustrative Plan



Illustrative Plan



Grant Frontier Park