

SITE MAP – CIVIC CENTER MEETING HALL

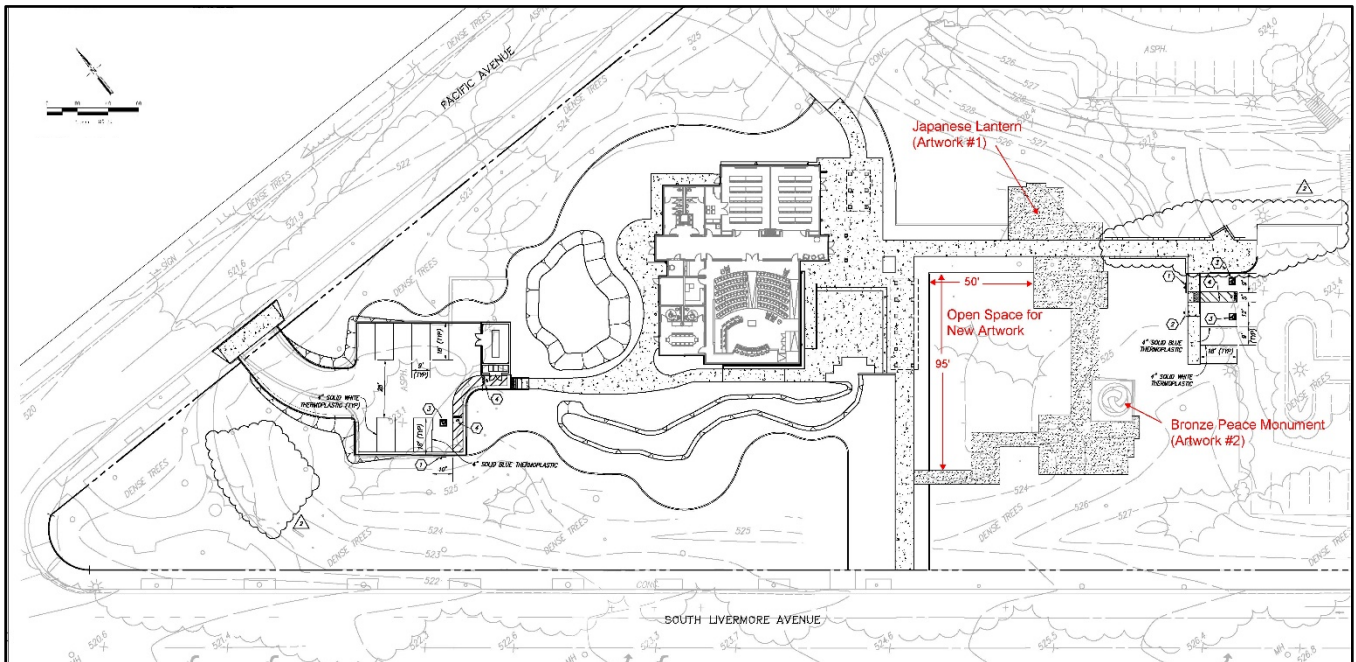

Site location on South Livermore Avenue near the corner of Pacific Avenue. The artwork will be installed in the open space in front of the new Meeting Hall. The front of the hall is oriented towards the Civic Center Complex to the southeast.

The open space is proposed as a sculpture garden with independent art pieces to be installed over time. The Civic Center Meeting Hall artwork will be the third art piece on this site. The specific installation location will be determined after the artwork has been selected.

This medium to large artwork will be viewed from the street, sidewalk, walkways, footpaths, and the Civic Center Complex, as well as from the gathering area in front of the Meeting Hall. The artwork must present an interesting visual experience from all directions (no front and back pieces).

Legend

Open Space for New Artwork –artwork will be installed in this open space area

Japanese Lantern (Artwork #1) – location of existing artwork

Bronze Peace Monument (Artwork #2) – location of existing artwork



- Foot path with planters through grass area to the existing artwork

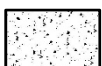

- Walkway from Civic Center complex, and from S Livermore Avenue, to front of Meeting Hall. The walkway from the Civic Center complex will be the preferred access route. Both walkways open onto a large gathering area in front of the hall.

The open space has a high overhead canopy from mature deciduous trees. There are areas in the center and in the upper left corner (see the open space area in the drawing above), where there is no tree canopy; however, artists should consider falling leaves from deciduous trees when proposing low-maintenance or maintenance-free artwork.

Existing Artwork

Japanese Lantern (Artwork #1)



Bronze Peace Monument (Artwork #2)

