

ROADWAY PLANS (10A)
MATCHLINE STA. 210+00.00

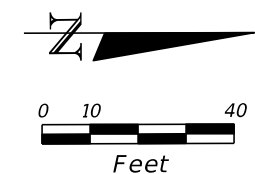

END MILLING & RESURFACING
BEGIN RECONSTRUCTION
STA. 201+50.00
CONST. 14TH EB - 1

END PROJECT
END RECONSTRUCTION
BEGIN MILLING AND RESURFACING
STA. 1059+00.00
SURVEY SR 45

END RECONSTRUCTION
BEGIN MILLING & RESURFACING
STA. 215+64.76
CONST. 14TH WB

MATCHLINE STA. 215+80.00
ROADWAY PLANS (11A)

MATCHLINE STA. 1055+00.00

MATCHLINE STA. 1061+80.00

REVISIONS			
DATE	DESCRIPTION	DATE	DESCRIPTION

LOCHNER
4550 W. CYPRESS STREET, SUITE 800
TAMPA, FLORIDA 33607
FBPR CERTIFICATE OF AUTH. # 894
STEPHAN J. VERBERNE, P.E. # 64713

STATE OF FLORIDA DEPARTMENT OF TRANSPORTATION		
ROAD NO.	COUNTY	FINANCIAL PROJECT ID
SR 45	SARASOTA	4283831-52-01

ROADWAY PLANS (6A)

SHEET NO.
51

THE OFFICIAL RECORD OF THIS SHEET IS THE ELECTRONIC FILE DIGITALLY SIGNED AND SEALED UNDER RULE 61G15-23.004, F.A.C.

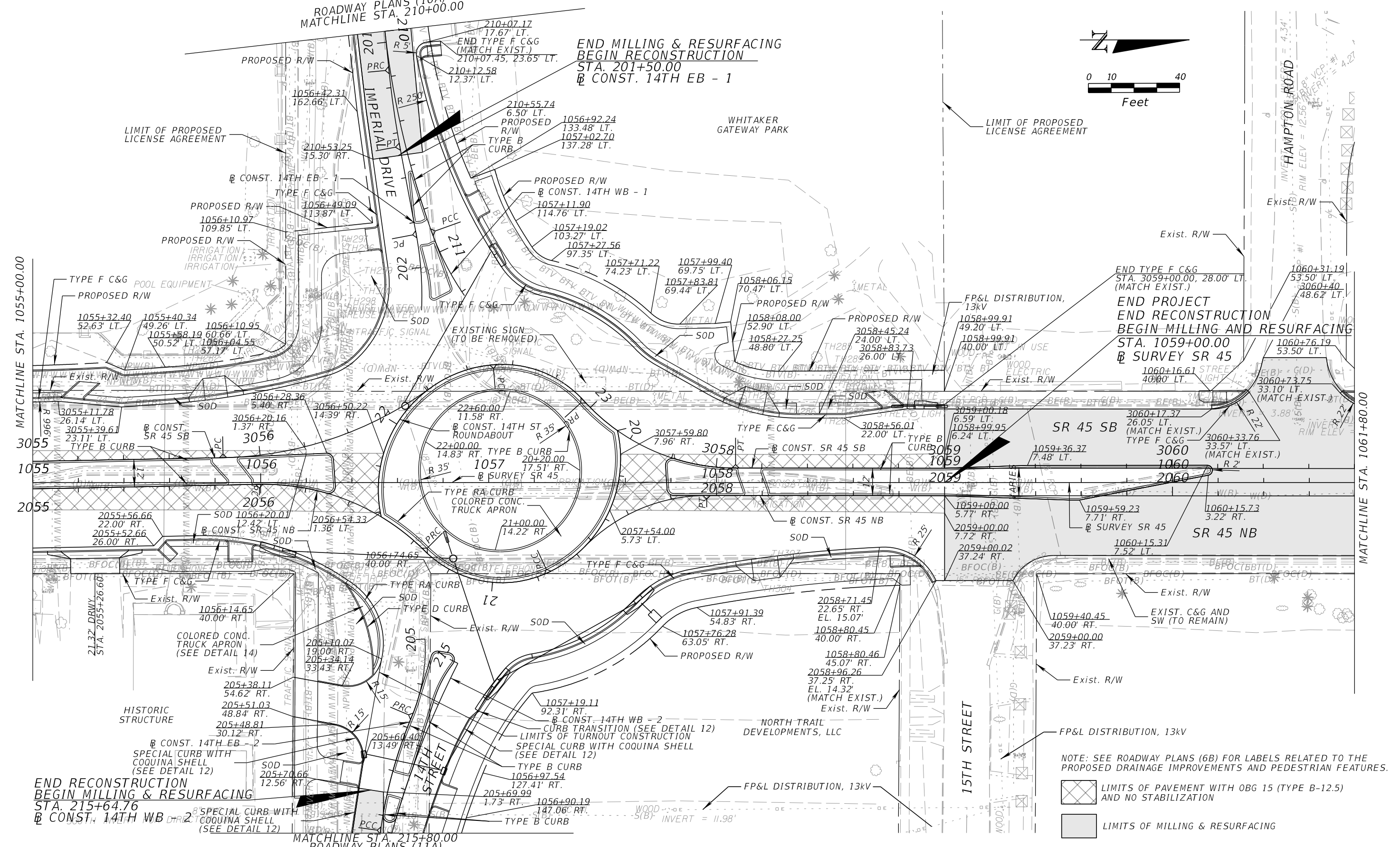

SIGHT DISTANCE PER EXHIBIT 6-59 FEDERAL HIGHWAY INFORMATION GUIDE CONFLICTING APPROACH SPEED 15 MPH COMPUTED DISTANCE 110.1 FEET - NATIONAL COOPERATIVE HIGHWAY RESEARCH PROGRAM (NCHRP REPORT 272).

NOTE: SEE TABULATION OF QUANTITIES SHEET FOR PLANT SYMBOL IDENTIFICATION.

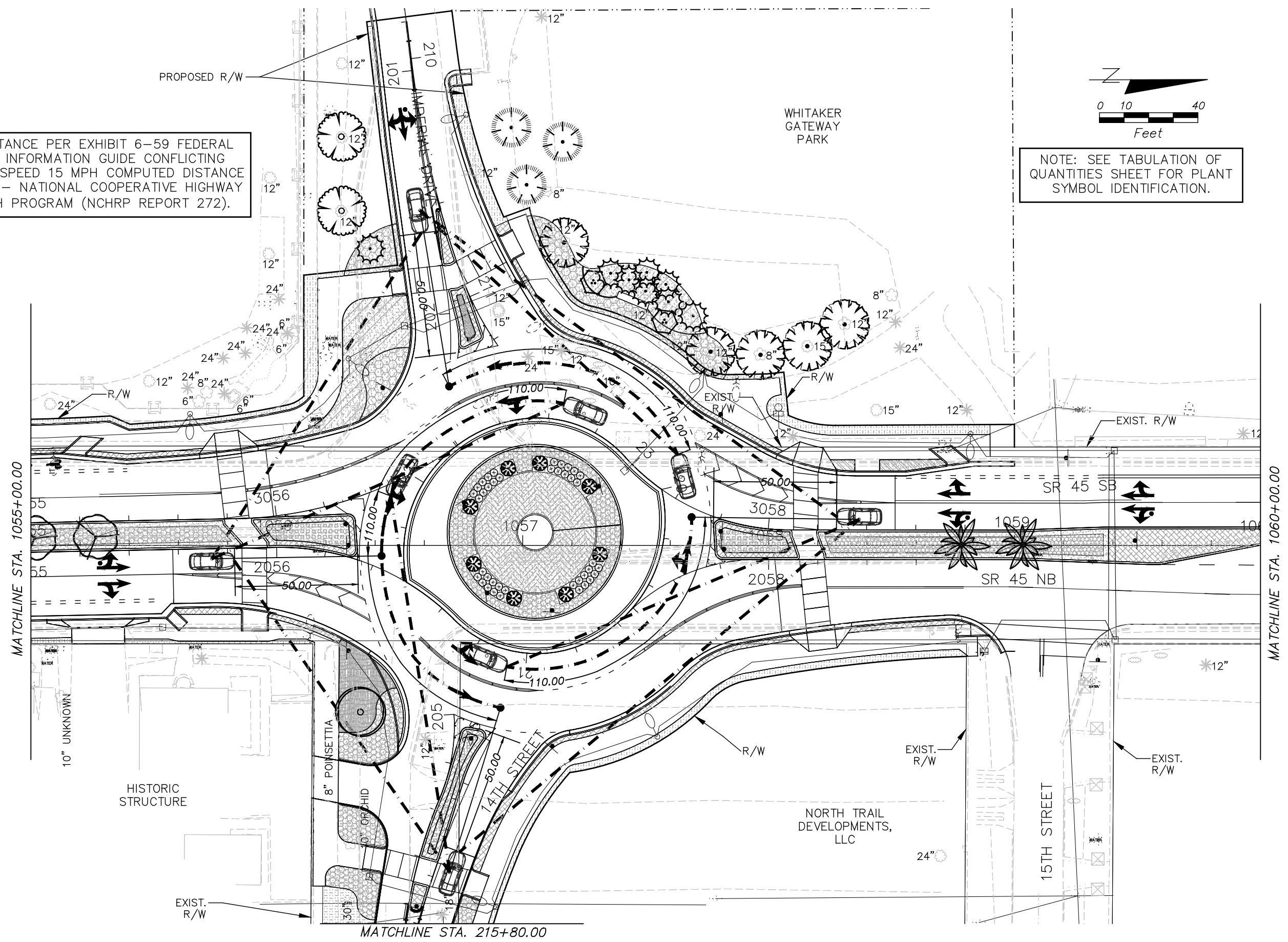
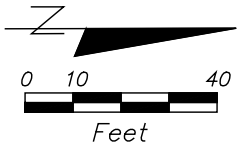

MATCHLINE STA. 1055+00.00

MATCHLINE STA. 1060+00.00

MATCHLINE STA. 215+80.00

REVISIONS				DAVID W. JOHNSTON ASSOCIATES, INC. 630 S. ORANGE AVENUE SUITE 202 SARASOTA, FL. 34236 LANDSCAPE ARCHITECT OF RECORD: PHILLIP J. SMITH R.L.A. NO. 1096 CERTIFICATION OF AUTHORIZATION LCC 000083	STATE OF FLORIDA DEPARTMENT OF TRANSPORTATION			LANDSCAPE DETAILS	SHEET NO. LD-37
DATE	DESCRIPTION	DATE	DESCRIPTION		ROAD NO.	COUNTY	FINANCIAL PROJECT ID		
					SR 45	SARASOTA	428383-1-52-03		

THE OFFICIAL RECORD OF THIS SHEET IS THE ELECTRONIC FILE SIGNED AND SEALED UNDER RULE 61G10-11.011, F.A.C.