

LONGITUDINAL SECTION ALONG CL ROADWAY

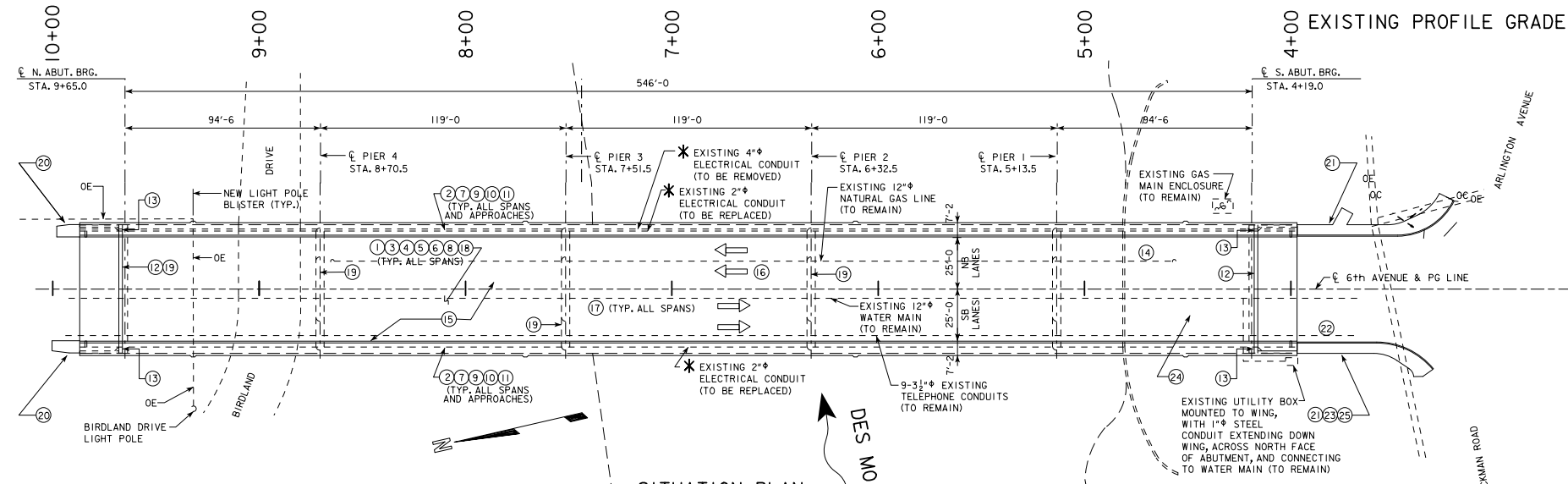

WORK ON THIS PROJECT SHALL GENERALLY CONSIST OF:  
 (SEE SHEET 0.01 FOR ADDITIONAL INFORMATION RELATING TO ROADWAY, APPROACH, AND SITE IMPROVEMENTS.)  
 1. REMOVE EXISTING ASPHALT WEARING SURFACE, AND MILL CONCRETE DECK WITHIN LIMITS INDICATED IN PLANS.  
 2. REMOVE EXISTING RAISED SIDEWALK SLABS, SEPARATION BARRIERS, AND EXTERIOR BARRIERS ON BRIDGE AND APPROACHES.  
 3. BRIDGE FLOOR REPAIR, CLASS A.  
 4. BRIDGE FLOOR REPAIR, CLASS B.  
 5. BRIDGE FLOOR REPAIR, CLASS A (MILLING).  
 6. PLUG EXISTING WEEP DRAINS.  
 7. INSTALL NEW RAISED SIDEWALK SLABS WITH NEW LIGHT POLE BLISTERS.  
 8. BRIDGE DECK OVERLAY.  
 9. INSTALL NEW RETROFIT BARRIER RAILS.  
 10. INSTALL NEW SIDEWALK FENCE ON BRIDGE.  
 11. INSTALL STEEL PIPE HAND RAIL ON NEW RETROFIT BARRIER RAIL.  
 12. REPLACE NEOPRENE STRIP SEALS AT ABUTMENT DECK JOINTS.  
 13. INSTALL NEW NEOPRENE STRIP SEALS AND COVER PLATES AT ABUTMENT DECK JOINTS.  
 14. REPAIR STEEL CROSS FRAME.  
 15. GRIND / REPAIR GIRDER WELD.  
 16. DRILL FLANGE BOLT HOLE AT GIRDER SPLICE AND INSTALL NEW BOLT.  
 17. CLEAN AND PAINT STRUCTURAL STEEL.  
 18. LONGITUDINAL GROOVING OF DECK.  
 19. CONCRETE REPAIR OF SUBSTRUCTURES.  
 20. APPROACH SIDEWALK REPLACEMENT.  
 21. CURB AND GUTTER, APPROACH SIDEWALK REPLACEMENT.  
 22. FULL DEPTH PAVEMENT REPLACEMENT.  
 23. REPLACE STORM SEWER INTAKES.  
 24. BRIDGE ABUTMENT BERM REPAIR.  
 25. REPLACE CMP.

\* SEE LIGHTING SHEETS IN THESE PLANS FOR LOCATIONS OF NEW ELECTRICAL CONDUITS.

**TRAFFIC ESTIMATE**  
 ADT = 11,200 VPD (2004)  
 0% TRUCKS

**LOCATION**  
 6th AVENUE OVER DES MOINES RIVER  
 AND BIRDLAND DRIVE  
 T-79N, R-24W  
 SECTION 34  
 SAYLOR TWP  
 POLK COUNTY  
 FHWA NO. 004010

DESIGN FOR REPAIRS TO 0° SKEW  
**546'-0 X 50'-0 WITH 5'-0 SDWKS  
 CONT. WELDED PLATE GIRDER BR.**

SITUATION PLAN

6TH AVE. BRIDGE OVER DES MOINES RIVER  
 CITY ACTIVITY ID I2-2011-002  
 DECEMBER 2011

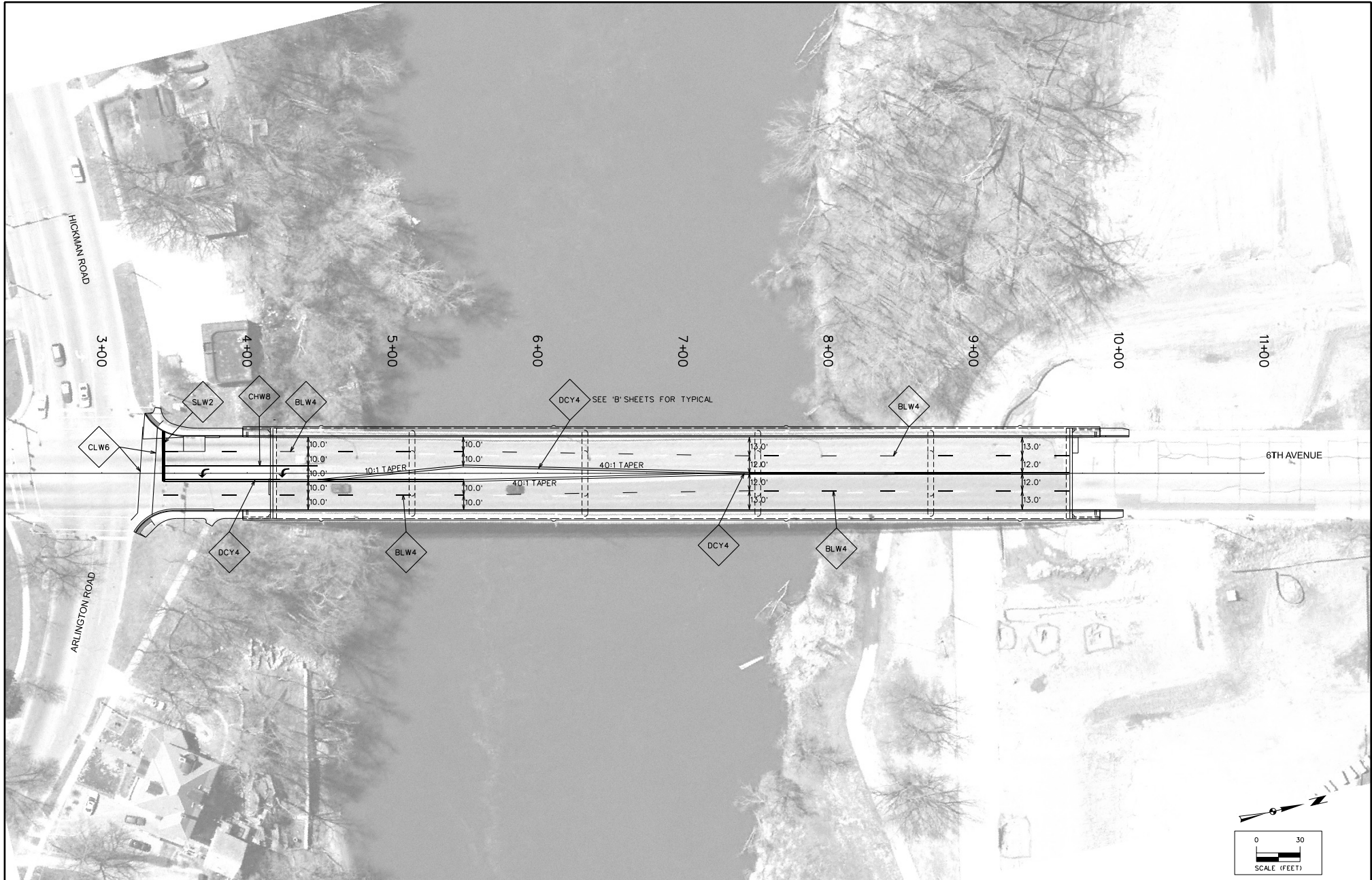

ENGLISH	IOWA DOT	DESIGN TEAM	<b>SNYDER &amp; ASSOCIATES</b>	POLK COUNTY	PROJECT NUMBER	STP-U-1945(787)--70-77	SHEET NUMBER	K.01
BTJ	12/30/2011	D:\1110450\cadd\cd_1110450.k01		V:\print_drivers\Block_Gray\psbw_half.plt	V:\PENNDATE.TBL		K.01	Snyder 160